

FEATURES

- Reliability: steel spool & sleeve technology with long service life
- Robust valve design, particularly recommended for use in high-temperature or dirty environments

GENERAL

Fluids	Air or neutral gas, filtered, lubricated or not
Operating pressure	1 to 10 bar (with internal supply to pilot) -0,950 to 15 bar (with external supply to pilot)
Ambient temperature	-20°C to +80°C
Flow (Qv at 6 bar)	See "SPECIFICATIONS"

CONSTRUCTION

Body	Aluminium, anodised, painted grey
Internal parts	Stainless steel, POM (polyacetal), aluminium
Static seals	NBR (nitrile)



INTEGRATED PILOT

Seals	NBR (nitrile)
Electrical equipment	Conforming to VDE 0580
Solenoid coil	Encapsulated
Exhaust	Over brass exhaust protector

ELECTRICAL CHARACTERISTICS

	voltage	consumption		insulation class	protection degree	electrical connection
		inrush	hold			
~	24V - 48V - 115V - 230V / 50Hz	10 VA	7 VA	F	IP 65	spade plug size 22 connector DIN 43650, 11 mm industry standard B
=	24V - 48V	3,35 W				

SPECIFICATIONS

	function symbol	operators pilot (14) solenoid air operated return (12)	port size	flow		catalogue number without connector ⁽¹⁾	(M)
				at 6 bar l/min	Kv m³/h		
5/2		spring return	G 1/8	1000	0,87	L11BA452XG000YY	●
			G 1/4			L12BA452XG000YY	
	solenoid air operated return	G 1/8	L11BB452XG000YY			●	
		G 1/4	L12BB452XG000YY				
5/3		pressure held W1	G 1/8			L11BB652XG000YY	●
			G 1/4			L12BB652XG000YY	
	pressure applied W2	G 1/8	L11BB752XG000YY			●	
		G 1/4	L12BB752XG000YY				
	pressure released W3	G 1/8	L11BB552XG000YY	●			
		G 1/4	L12BB552XG000YY				

(M) Type of manual operator on pilot(s): ● : maintained

(1) For connectors see page P935-1

type of current	X
AC (alternating current)	0
DC (direct current)	B
voltage	YY
24V DC / 48 VAC - 50/60 Hz	61
115 VAC - 50/60 Hz	30
24 VAC - 50/60 Hz	20
230 VAC - 50/60 Hz	40

OPTIONS (upon request)

- Low power consumption 1,4 W (only in DC)
- Version for higher pressures up to 15 bar
- Version for higher temperatures up to 150 °C
- Stainless steel body
- Equipment for use in potentially explosive gas or dust atmospheres (ATEX directive 94/9/EC)

DIMENSIONS (mm), WEIGHT (kg)

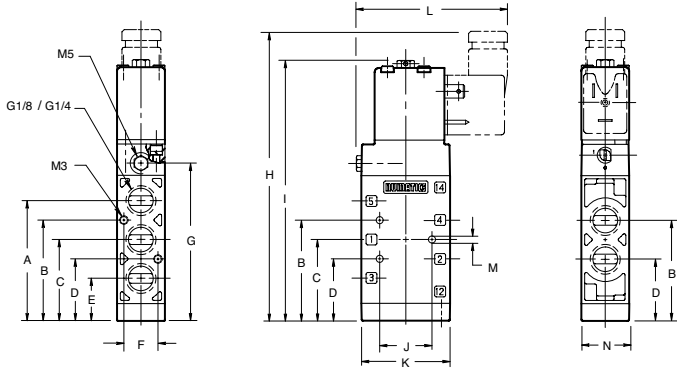

L11 / L12 BA4..

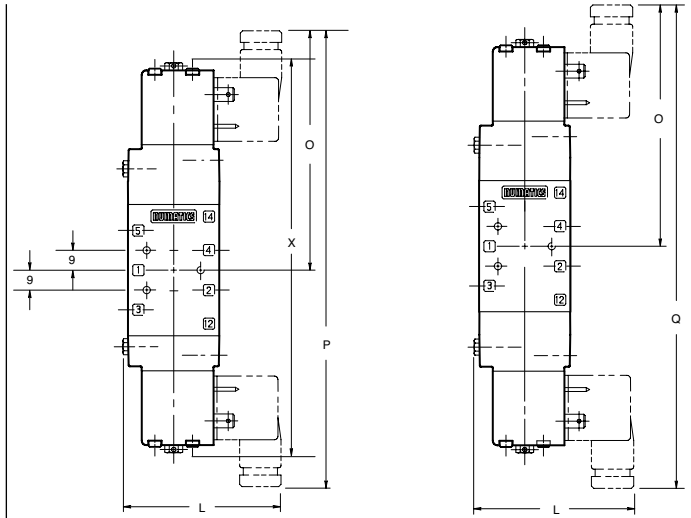

L11 / L12 BB4/5/6/7..

External air supply in M5

catalogue number	A	B	C	D	E	F	G	H	I	J	K	L	M	N	O	P	Q	weight approx.
L11BA4..																		
L12BA4..																		
L11BB4/5/6/7..	56,1	47,0	38,1	29,0	19,8	15,7	73,6	137,4	123,2	24,4	41,1	70,4	3,3	22,4	109,7	209,0	219,5	0,270
L12BB4/5/6/7..																		0,420

SUBBASES



Multiple subbase
front mounting
threaded ports G 1/4

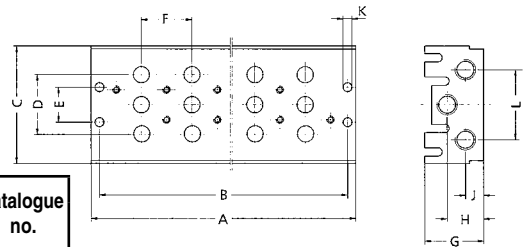

number of valve stations	dimensions											weight approx.	catalogue no.
	A	B	C	D	E	F	G	H	J	K	L		
2	88,5	78,5	70,6	36,0	21,0	30,5	35,5	22,0	11,0	5,3	42,0	0,410	106-540
3	119,0	109,0	70,6	36,0	21,0	30,5	35,5	22,0	11,0	5,3	42,0	0,550	106-541
4	149,5	139,5	70,6	36,0	21,0	30,5	35,5	22,0	11,0	5,3	42,0	0,690	106-542
5	180,0	170,0	70,6	36,0	21,0	30,5	35,5	22,0	11,0	5,3	42,0	0,830	106-543
6	210,5	200,5	70,6	36,0	21,0	30,5	35,5	22,0	11,0	5,3	42,0	0,970	106-544
7	241,0	231,0	70,6	36,0	21,0	30,5	35,5	22,0	11,0	5,3	42,0	1,120	106-545
8	271,5	261,5	70,6	36,0	21,0	30,5	35,5	22,0	11,0	5,3	42,0	1,260	106-546
9	302,0	292,0	70,6	36,0	21,0	30,5	35,5	22,0	11,0	5,3	42,0	1,400	106-547
10	332,5	322,5	70,6	36,0	21,0	30,5	35,5	22,0	11,0	5,3	42,0	1,540	106-548
11	363,0	353,0	70,6	36,0	21,0	30,5	35,5	22,0	11,0	5,3	42,0	1,680	106-549
12	393,5	383,5	70,6	36,0	21,0	30,5	35,5	22,0	11,0	5,3	42,0	1,820	106-550

Note: Valves can only be mounted on subbase with adapter plate **239-311**

ACCESSORIES

illustration	designation	application	dimensions			weight approx.	catalogue number
			length	width	height		
	Adapter plate*	1 plate per station	59,2	22,1	5,6	0,020	239-311
	Blanking plate**	only for multiple subbase, front mounting	59,2	22,1	11,9	0,040	239-288
—	Blocking plugs	to separate channels "1", "3" & "5"	—	—	—	—	20.5499
—	Blocking screws G 1/4	to close ports "1" and/or "3" & "5"	—	—	—	—	AJ233.03-N

* Including screws and seals

** Blanking plate inclusive of adapter plate **239-311**

FEATURES

- Reliability: steel spool & sleeve technology with long service life
- Robust valve design, particularly recommended for use in high-temperature or dirty environments

GENERAL

Fluids	Air or neutral gas, filtered, lubricated or not
Operating pressure	1 to 10 bar (with internal supply to pilot) -0,950 to 15 bar (with external supply to pilot)
Ambient temperature	-20°C to +80°C
Flow (Qv at 6 bar)	See "SPECIFICATIONS"

CONSTRUCTION

Body	Aluminium, anodised, painted grey
Internal parts	Stainless steel, POM (polyacetal), aluminium
Static seals	NBR (nitrile)

INTEGRATED PILOT

Seals	NBR (nitrile)
Electrical equipment	Conforming to VDE 0580
Solenoid coil	Encapsulated
Exhaust	Over brass exhaust protector

ELECTRICAL CHARACTERISTICS

	voltage	consumption		insulation class	protection degree	electrical connection
		inrush	hold			
~	24V - 48V - 115V - 230V / 50Hz	10 VA	7 VA	F	IP 65	spade plug size 22 connector DIN 43650, 11 mm industry standard B
=	24V - 48V	3,35 W				



SPECIFICATIONS

function symbol	operators pilot (14) solenoid air operated return (12)	Anschluss	flow		catalogue number without connector ⁽¹⁾	(M)
			at 6 bar l/min	Kv m³/h		
	spring return	G 1/4	1700	1,48	L22BA452XG000YY	●
		G 3/8			L23BA452XG000YY	
	solenoid air operated return	G 1/4			L22BB452XG000YY	●
		G 3/8			L23BB452XG000YY	
	pressure held W1	G 1/4	1700	1,48	L22BB652XG000YY	●
		G 3/8			L23BB652XG000YY	
	pressure applied W2	G 1/4			L22BB752XG000YY	●
		G 3/8			L23BB752XG000YY	
	pressure released W3	G 1/4			L22BB552XG000YY	●
		G 3/8			L23BB552XG000YY	

(M) Type of manual operator on pilot(s): ● : maintained
(1) For connectors see page P935-1

type of current	X
AC (alternating current)	0
DC (direct current)	B

voltage	YY
24V DC / 48 VAC - 50/60 Hz	61
115 VAC - 50/60 Hz	30
24 VAC - 50/60 Hz	20
230 VAC - 50/60 Hz	40

OPTIONS (upon request)

- Low power consumption 1,4 W (only in DC)
- Version for higher pressures to 15 bar (21 bar).
- Version for higher temperatures up to 150 °C.
- Stainless steel body
- Equipment for use in potentially explosive gas or dust atmospheres (ATEX directive 94/9/EC)

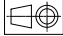
DIMENSIONS (mm), WEIGHT (kg) 

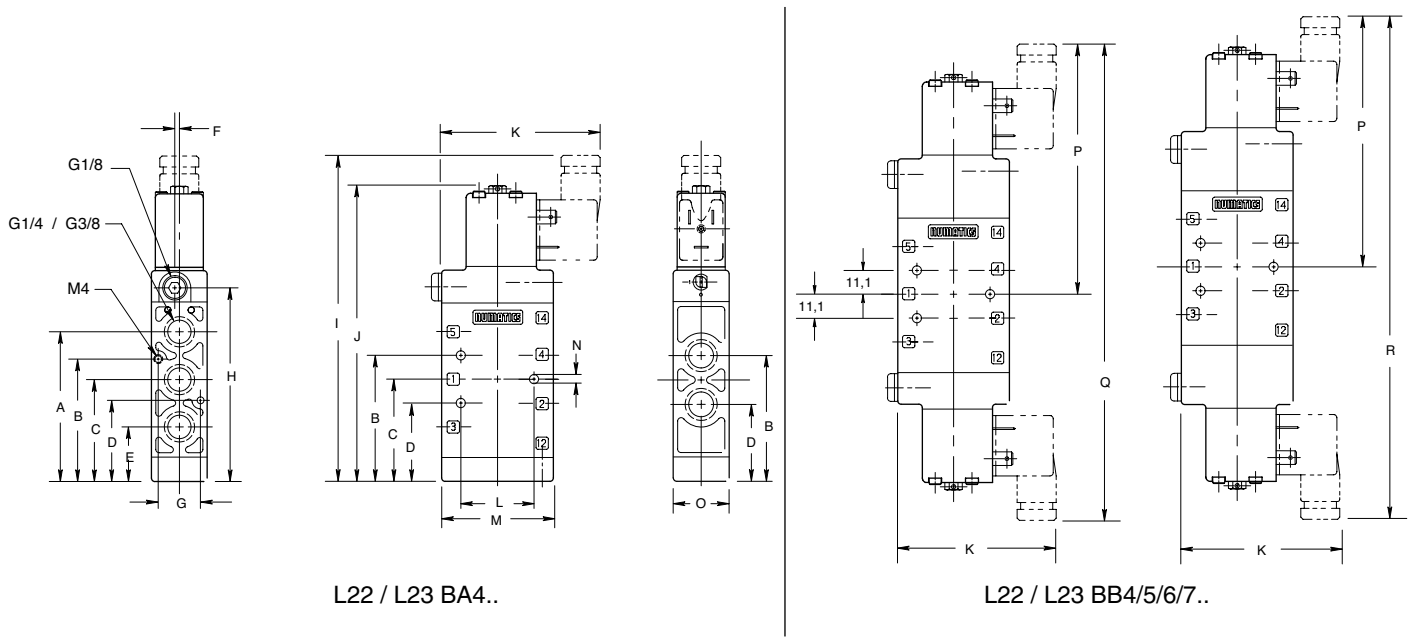

External air supply in G 1/8

catalogue number	A	B	C	D	E	F	G	H	I	J	K	L	M	N	O	P	Q	R	weight approx.
L22BA4.. L23BA4..	69,1	57,9	47,0	35,8	24,6	2,0	19,1	89,7	152,1	136,7	72,9	32,3	50,8	4,3	25,4	118,4	223,0	236,7	0,390
L22BB4/5/6/7.. L23BB4/5/6/7..																			0,550

SUBBASES



Multiple subbase
Front mounting
Threaded ports G 3/8

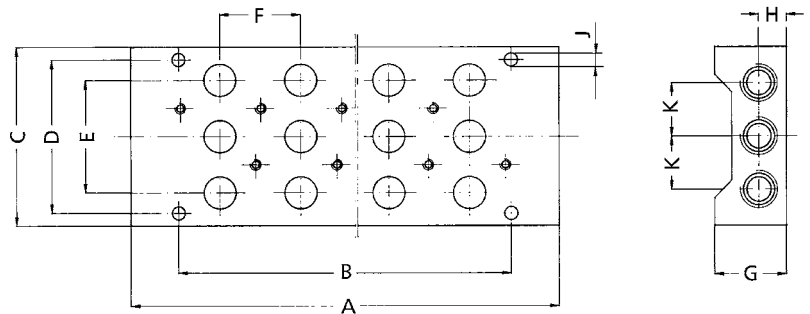

number of valve stations	dimensions											weight approx.	catalogue number
	A	B	C	D	E	F	G	H	J	K			
2	105,4	67,0	70,5	63,4	44,4	32,0	30,6	212,4	4,1	22,2	0,410	106-715	
3	137,4	99,4	70,5	63,4	44,4	32,0	30,6	212,4	4,1	22,2	0,540	106-716	
4	169,4	131,4	70,5	63,4	44,4	32,0	30,6	212,4	4,1	22,2	0,670	106-717	
5	201,4	163,4	70,5	63,4	44,4	32,0	30,6	212,4	4,1	22,2	0,800	106-718	
6	233,4	195,4	70,5	63,4	44,4	32,0	30,6	212,4	4,1	22,2	0,939	106-719	
7	265,4	255,4	70,5	63,4	44,4	32,0	30,6	212,4	4,1	22,2	1,060	106-720	
8	297,4	259,4	70,5	63,4	44,4	32,0	30,6	212,4	4,1	22,2	1,190	106-721	
9	329,4	291,4	70,5	63,4	44,4	32,0	30,6	212,4	4,1	22,2	1,320	106-722	
10	361,4	323,4	70,5	63,4	44,4	32,0	30,6	212,4	4,1	22,2	1,450	106-723	
11	393,4	355,4	70,5	63,4	44,4	32,0	30,6	212,4	4,1	22,2	1,580	106-724	
12	425,4	387,4	70,5	63,4	44,4	32,0	30,6	212,4	4,1	22,2	1,710	106-725	

Note: Valves can only be mounted on subbase with adapter plate **239-312**

SUBBASES



Multiple subbase
Rear mounting
Threaded ports G 3/8

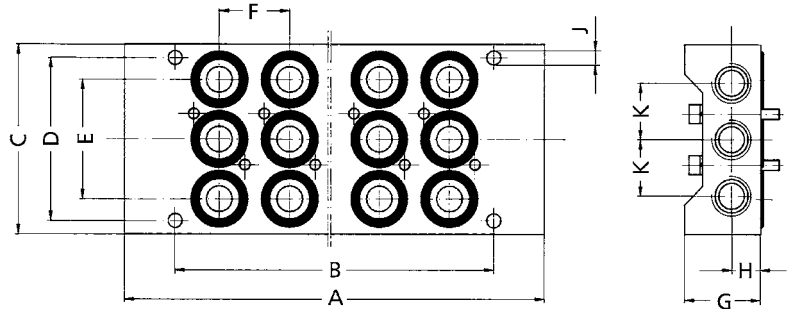

number of valve stations	dimensions										weight approx.	catalogue number
	A	B	C	D	E	F	G	H	J	K		
2	99,6	61,0	70,5	63,4	44,4	26,2	28,7	11,4	4,1	22,2	0,360	229-979
3	127,7	87,1	70,5	63,4	44,4	26,2	28,7	11,4	4,1	22,2	0,460	229-980
4	151,9	113,3	70,5	63,4	44,4	26,2	28,7	11,4	4,1	22,2	0,560	229-981
5	178,1	139,4	70,5	63,4	44,4	26,2	28,7	11,4	4,1	22,2	0,660	229-982
6	204,2	165,6	70,5	63,4	44,4	26,2	28,7	11,4	4,1	22,2	0,750	229-983
7	230,4	191,8	70,5	63,4	44,4	26,2	28,7	11,4	4,1	22,2	0,850	229-984
8	256,5	217,9	70,5	63,4	44,4	26,2	28,7	11,4	4,1	22,2	0,950	229-985
9	282,7	244,1	70,5	63,4	44,4	26,2	28,7	11,4	4,1	22,2	1,050	229-986
10	308,9	270,3	70,5	63,4	44,4	26,2	28,7	11,4	4,1	22,2	1,140	229-987
11	335,0	296,4	70,5	63,4	44,4	26,2	28,7	11,4	4,1	22,2	1,240	229-988
12	361,2	322,6	70,5	63,4	44,4	26,2	28,7	11,4	4,1	22,2	1,340	229-989

Including screws and seals
NPTF thread upon request

E





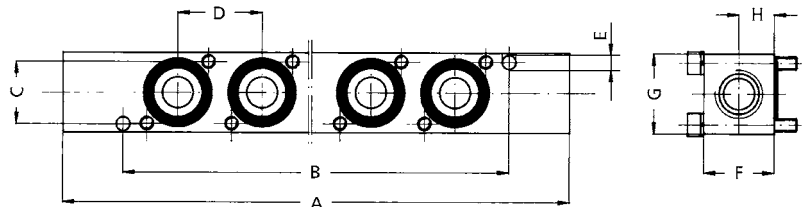



P supply rail
Threaded ports G 3/8



number of valve stations	dimensions									weight approx.	catalogue number
	A	B	C	D	E	F	G	H			
2	99,6	61,0	19,0	26,2	4,1	22,9	24,6	11,4	0,110	229-957	
3	127,7	87,1	19,0	26,2	4,1	22,9	24,6	11,4	0,140	229-958	
4	151,9	113,3	19,0	26,2	4,1	22,9	24,6	11,4	0,170	229-959	
5	178,1	139,4	19,0	26,2	4,1	22,9	24,6	11,4	0,200	229-960	
6	204,2	165,6	19,0	26,2	4,1	22,9	24,6	11,4	0,230	229-961	
7	230,4	191,8	19,0	26,2	4,1	22,9	24,6	11,4	0,260	229-962	
8	256,5	217,9	19,0	26,2	4,1	22,9	24,6	11,4	0,290	229-963	
9	282,7	244,1	19,0	26,2	4,1	22,9	24,6	11,4	0,330	229-964	
10	308,9	270,3	19,0	26,2	4,1	22,9	24,6	11,4	0,360	229-965	
11	335,0	296,4	19,0	26,2	4,1	22,9	24,6	11,4	0,390	229-966	
12	361,2	322,6	19,0	26,2	4,1	22,9	24,6	11,4	0,420	229-967	

Including screws and seals
NPTF thread upon request

ACCESSORIES

illustration	designation	application	dimensions			weight approx.	catalogue number
			length	width	height		
	Valve isolating plate*	to block supply channel 1 for valve replacement without system depressurisation	70,1	25,4	20,0	0,150	10.6445
	Adapter plate*	1 plate per station only for multiple subbase, front mounting	70,1	25,4	7,14	0,020	239-312
	Blanking plate*	only for multiple subbase, front mounting	70,1	25,4	13,5	0,050	239-471
	Blanking plate*	only for multiple subbase, rear mounting	71,1	25,4	6,35	0,030	229-991
	Blanking plate*	only for P supply rail	25,4	24,6	6,35	0,020	229-990
	Sandwich flow regulator*	only for multiple subbase, front and rear mounting	—	—	—	0,080	239-209
—	Blocking plugs	to separate channels "1", "3" & "5"	—	—	—	—	20.5499
—	Blocking screws G 3/8	to close ports "1" and/or "3" & "5"	—	—	—	—	AJ233.04-N

* Including screws and seals

MOUNTING ARRANGEMENT

