

Compressed air maintenance unit, series AS3-Inch

FRL Maintenance unit AS3-ACT, 3-in-1, 3/8 NPT - 1/2 NPT, ATEX approved

AVENTICS®



Technical Data

Type	Filter Pressure regulator Lubricator	Filter element replaceable Diaphragm-type pressure regulator with relief opening, reverse flow capability, and lockable regulator knob Standard oil-drop lubricator with semi-automatic oil filling Fill level – sight glass with slotted screw adjustment for oil metering Can be filled with oil during operation semi-automatic: 7 ... 232 psi fully automatic: 21 ... 232 psi See table See table
Supply pressure	Condensate drain	
Secondary pressure		See table
Nominal flow Qn		See table
Secondary pressure = 91 psi and Δp = 15 psi		
Temperature range		–10° to +50 °C (14 °F ... 122 °F) *
Medium		Compressed air
Weight		See table
Installation position		Vertical
Materials	Body Thread insert Reservoir Bowl guard Cover Filter element	Polyamide, seals Buna-N(NBR) Die-cast zinc Polycarbonate or die cast zinc, with bayonet catch Polyamide (polycarbonate bowls only) ABS Polyethylene
Reservoir capacity	Filter Lubricator	49 cm³ (1.6 U.S. Fl oz) (semi-automatic) 80 cm³ (2.7 U.S. Fl oz)
Filter porosity		5 μm
ATEX	In zone 1 (gas-ex, category 2G) In zone 21 (dust-ex, category 2D) In zone 2 (gas-ex, category 3G) In zone 22 (dust-ex, category 3D)	

* with dried air

Filter for separating solid impurities up to 5 μm from compressed air and gases

For quality classes according to DIN ISO 8573-1

- Solid impurities: class 3

- Humidity - water content: class 8

Oil type: HL 68 (DIN 51 524 - ISO VG 68)

Standard values for oil metering: 1-2 drops / min at a nominal flow rate of Qn = 35.30 CFM

Plastic containers may only be cleaned with water, soap suds, and other similar, neutral agents.

► - semi and fully automatic condensate drain*

* either opened without pressure (NO) or closed without pressure (NC)

Note: All Series AS filter drains include a manual drain function as standard.



Part no.

Symbol	Threaded ports	Nominal flow Qn [CFM]	Secondary pressure [psi]	Options	Weight [lbs.]	Part no. with pressure gauge (Poly./Metal)
	3/8 NPT	123	7 ... 116	Polycarbonate w/guard or metal bowl, semi-automatic, without pressure: open	2.98	R432002011/R432002230
	3/8 NPT	123	21 ... 116	Polycarbonate w/guard or metal bowl, fully automatic, without pressure: open	3.09	R432002012/R432002231
	3/8 NPT	123	0 ... 116	Polycarbonate w/guard or metal bowl, fully automatic, without pressure: closed	3.09	R432002013/R432002232
	1/2 NPT	123	7 ... 116	Polycarbonate w/guard or metal bowl, semi-automatic, without pressure: open	2.98	R432002014/R432002236
	1/2 NPT	123	21 ... 116	Polycarbonate w/guard or metal bowl, fully automatic, without pressure: open	3.09	R432002015/R432002237
	1/2 NPT	123	0 ... 116	Polycarbonate w/guard or metal bowl, fully automatic, without pressure: closed	3.09	R432002016/R432002238

Nominal flow at inlet pressure 91 psi and 15 psi drop (P₁ = 6.3 bar, ΔP = 1 bar)

Accessories (to be ordered separately)

	Accessory	Part no.
	Spare parts kit: see filter pressure regulator valve AS3-FRE and oil-drop lubricator AS3-CBS	
	Mounting plate AS3-MBR-...-W01	R432031072
	Mounting strap AS3-MBR-...-W03	R412007370
	Block assembly kit AS3-MBR-...-W04	R412007371
	Mounting flange kit (3/8 inch) AS3-MBR-N038...-W05	R432002017
	Mounting flange kit (1/2 inch) AS3-MBR-N012...-W05	R432002018

Pneutrol International Limited
UK Office
5 Caulside Drive, Antrim, BT41 2DU
United Kingdom
TEL: +44 (0) 289448 1808
www.valves-direct.com

sales@pneutrol.com
European Office
Unit 6, Saint Anthony's Business Park, Ballymount Road, D22 VW95
Ireland
TEL: +353 (0) 1 4373653
www.valves-direct.com

Compressed air maintenance unit, series AS3-Inch

FRL Maintenance unit AS3-ACT, 3-in-1, 3/8 NPT - 1/2 NPT, ATEX approved

AVENTICS[®]

Lubrication activation margin

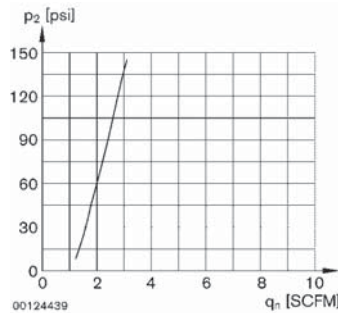

p_1 = Supply pressure; p_2 = Secondary pressure; q_n = Nominal flow

Flow rate characteristic (setting range p_2 : 7 to 116 psi)

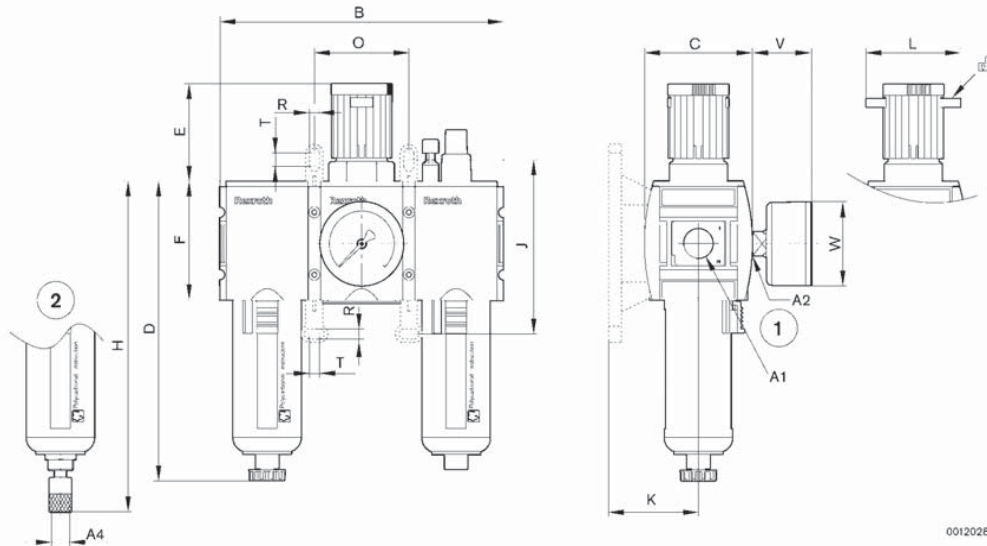
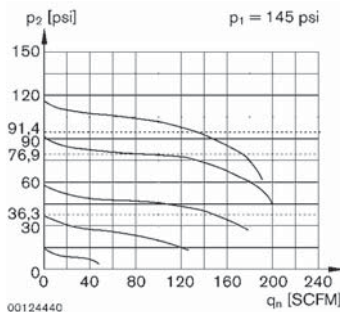

- 1) Semi-automatic condensate drain
- 2) Fully automatic condensate drain

A1	A2	A4	B	C	D	E	F	H	J	K	L	O	R	T	V	W
3/8 NPT	1/4 NPT	G 1/8	7.441	2.913	7.461	2.500	3.150	8.110	4.094	2.795	2.323	2.480	0.252	0.315	1.260	1.969
1/2 NPT	1/4 NPT	G 1/8	7.441	2.913	7.461	2.500	3.150	8.110	4.094	2.795	2.323	2.480	0.252	0.315	1.260	1.969

Dimensions in inches

Pneutrol International Limited
 UK Office
 5 Caulside Drive, Antrim, BT41 2DU
 United Kingdom
 TEL: +44 (0) 289448 1808
 www.valves-direct.com

sales@pneutrol.com
 European Office
 Unit 6, Saint Anthony's Business Park, Ballymount Road, D22 VW95
 Ireland
 TEL: +353 (0) 1 4373653
 www.valves-direct.com