

Series NU1

- bulkhead connector
- Ø 4 Ø 6 Ø 9
- Ø 4 Ø 6 Ø 9
- NU1-S-RSC



| | |
|-------------------------------|-----------------|
| Working pressure min./max. | 0 ... 10 bar |
| Ambient temperature min./max. | -10 ... 60 °C |
| Weight | See table below |

Technical data

| Part No. | Port G | Port D | Delivery unit | Weight |
|------------|--------|--------|---------------|----------|
| 1823391277 | Ø 4 | Ø 4 | 10 piece | 0,013 kg |
| 1823391278 | Ø 6 | Ø 6 | 10 piece | 0,015 kg |
| 1823391279 | Ø 9 | Ø 9 | 10 piece | 0,019 kg |

Weight per piece

Technical information

For further information about assembling and tolerances of adaptable tubing can be found in the "Technical information" document (available in the MediaCentre).

Technical information

| Material | |
|----------|------------------|
| Housing | Polyoxymethylene |

Dimensions

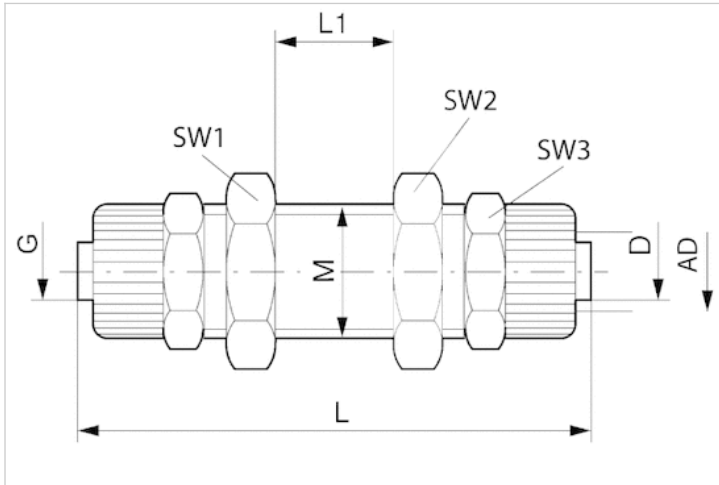

Dimensions

| Part No. | Port D | Port G | L | L1 1) | M | SW 1 | SW 2 | SW 3 | AD 2) |
|------------|--------|--------|------|-------|-------|------|------|------|-------|
| 1823391277 | Ø 4 | Ø 4 | 51.4 | 10 | M10x1 | 14 | 14 | 12 | 6 |
| 1823391278 | Ø 6 | Ø 6 | 51.4 | 10 | M12x1 | 17 | 17 | 14 | 8 |
| 1823391279 | Ø 9 | Ø 9 | 64 | 10 | M16x1 | 22 | 22 | 19 | 12 |

1) Max.

2) AD = external diameter of the tubing to be used

Connection D = inside diameter of the tubing to be used