

# Elbow fitting

- Internal thread
- G 1/8 G 1/4 G 3/8 G 1/2 G 3/4 G 1
- External thread
- R 1/8 R 1/4 R 3/8 R 1/2 R 3/4 R 1
- FPT-S-RLT



Working pressure min./max.

0 ... 16 bar

Ambient temperature min./max.

-20 ... 80 °C

## Technical data

Part No.	Port G	Port D	Delivery unit
1823391751	G 1/8	R 1/8	10 piece
1823391752	G 1/4	R 1/4	10 piece
1823391753	G 3/8	R 3/8	5 piece
1823391754	G 1/2	R 1/2	5 piece
1823391755	G 3/4	R 3/4	2 piece
1823391756	G 1	R 1	2 piece

## Technical information

Material	
Material	Brass, nickel-plated

## Dimensions

### Dimensions

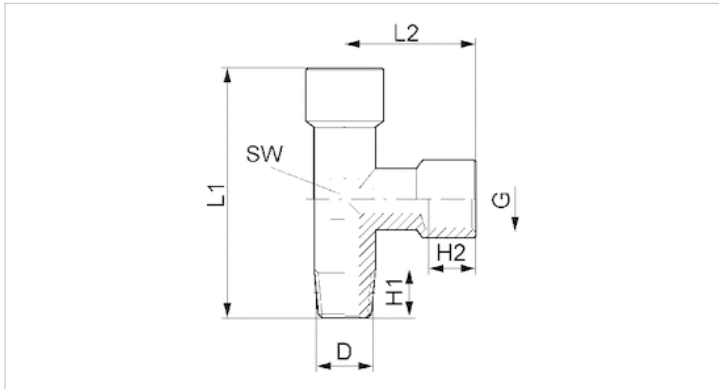

## Dimensions

Part No.	Port D	Port G	H1	H2	L1	L2	SW
1823391751	R 1/8	G 1/8	8.5	7	40	21	10
1823391752	R 1/4	G 1/4	11.5	9	49	25.5	13
1823391753	R 3/8	G 3/8	12.5	9.5	54.5	28	17
1823391754	R 1/2	G 1/2	13	13	64.5	33	21
1823391755	R 3/4	G 3/4	15	15	68.5	36.5	25
1823391756	R 1	G 1	17	17	84	45	30