

Distributor, Series AS1-DIS

- G 1/4
- Air supply left
- Distributor 2x
- Distributor



Version	Distributor, Can be assembled into blocks
Parts	Distributor
Mounting orientation	Any
Working pressure min./max.	0 ... 12 bar
Ambient temperature min./max.	-10 ... 50 °C
Medium temperature min./max.	-10 ... 50 °C
Medium	Compressed air Neutral gases
Weight	0,148 kg

Technical data

Part No.	Port	Nominal flow	Nominal flow	Nominal flow
		Qn 1►2	Qn 1►3	Qn 1►5
R412014662	G 1/4	2700 l/min	950 l/min	2000 l/min

Technical information

Material	
Housing	Polyamide
Front plate	Acrylonitrile butadiene styrene
Seals	Acrylonitrile butadiene rubber

Dimensions

Dimensions

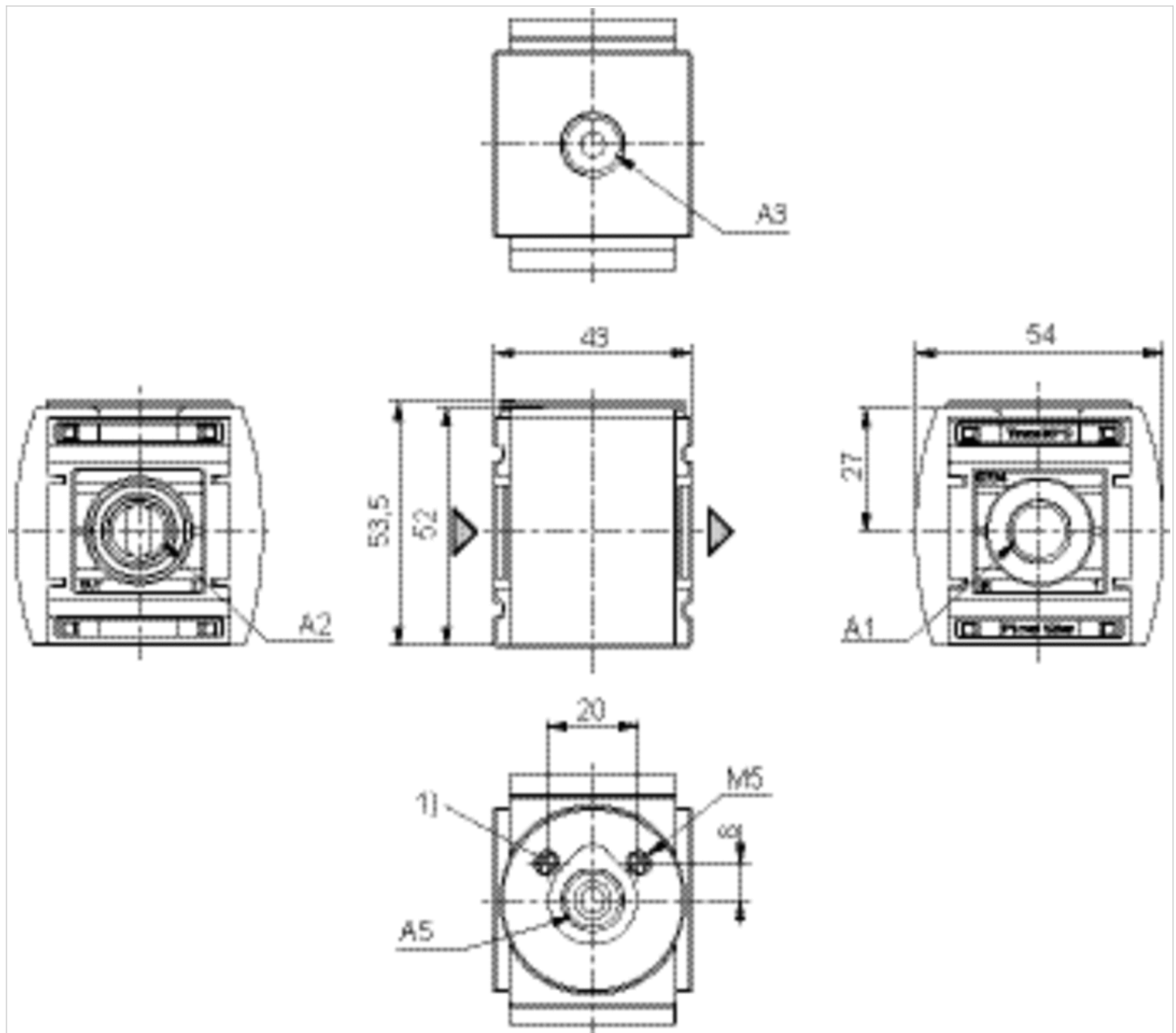

A1 = input

A2 = output

A3 = output

A5 = output

1) Mounting thread for pressure sensor