

# 3/2-shut-off valve, mechanically operated, Series AS5-BAV

- G 3/4 G 1
- lockable
- for padlocks
- suitable for ATEX

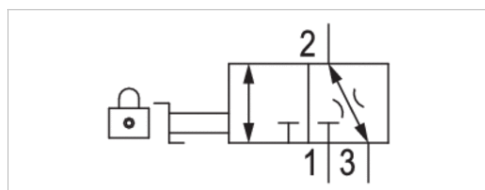

Version	Ball valve
Activation	Mechanical
Lock type	lockable
Actuating element	rotary switch
Sealing principle	metal/metal sealing
Certificates	suitable for ATEX
Working pressure min./max.	0 ... 16 bar
Ambient temperature min./max.	-10 ... 50 °C
Medium temperature min./max.	-10 ... 50 °C
Medium	Compressed air Neutral gases
Max. particle size	25 µm
Weight	0,825 kg



## Technical data

Part No.	Compressed air connection	
	Input	Output
R412009260	G 3/4	G 3/4
R412009261	G 1	G 1

Part No.	Compressed air connection	Flow	Flow	Lock type
	Exhaust	Qn 1 ► 2	Qn 2 ► 3	
R412009260	G 3/4	30000 l/min	130 l/min	for padlocks
R412009261	G 3/4	30000 l/min	130 l/min	for padlocks

Part No.	Locking base
R412009260	Steel galvanized
R412009261	Steel galvanized

Nominal flow Qn with secondary pressure p2 = 6 bar at Δp = 1 bar

Suitable for use in Ex zones 1, 2, 21, 22

## Technical information

The pressure dew point must be at least 15 °C under ambient and medium temperature and may not exceed 3 °C .  
Suitable for use in Ex zones 1, 2, 21, 22  
A change in the flow direction (from air supply on the left to air supply on the right) occurs by rotating installation by 180° about the vertical axis. Please see the operating instructions for further details.

Technical information

Material	
Housing	Polyamide
Front plate	Acrylonitrile butadiene styrene
Seals	Polytetrafluorethylene
Threaded bushing	Die cast zinc
Actuating element	Polyoxymethylene
Locking base	Steel, galvanized

Dimensions

Dimensions

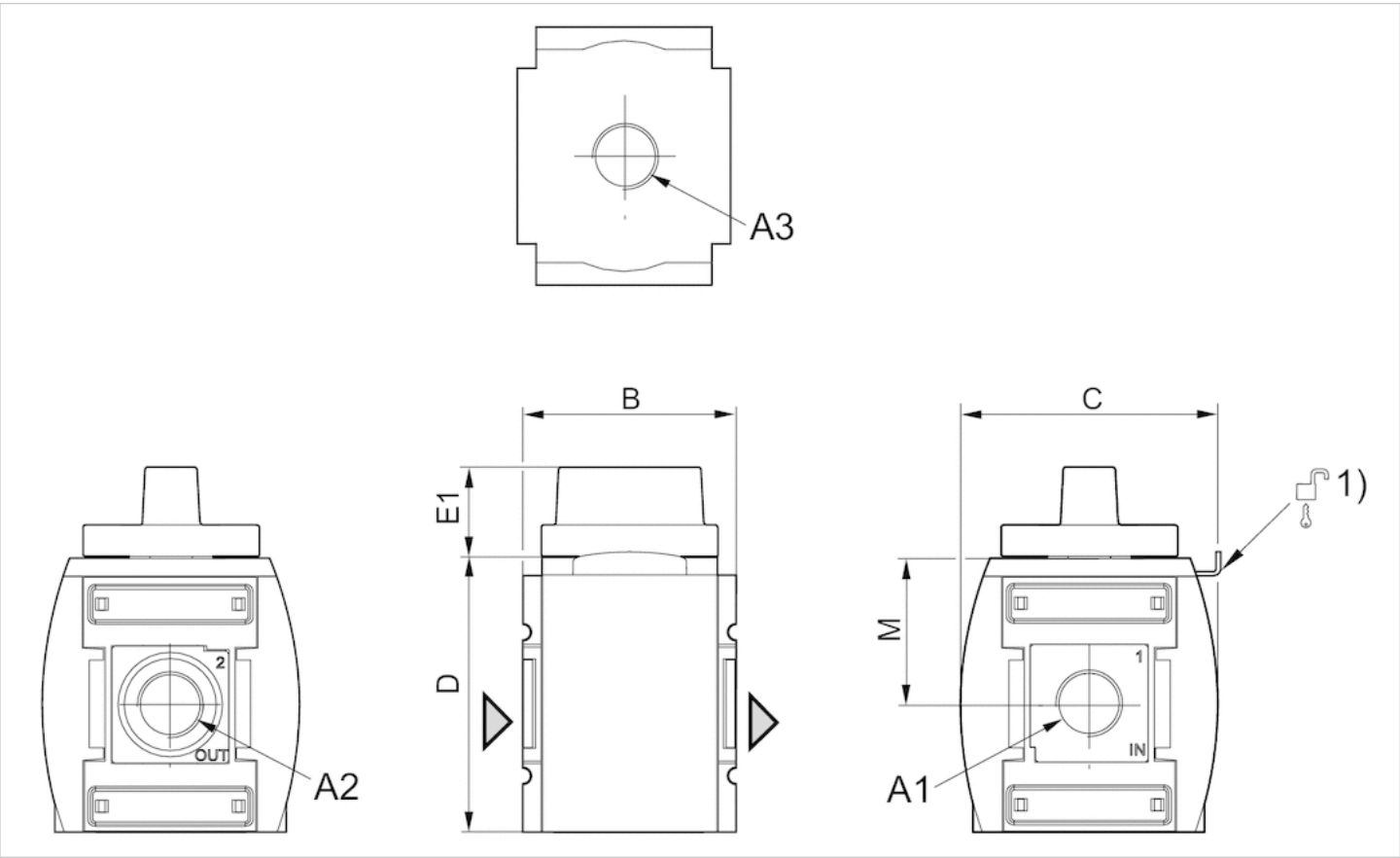

A1 = inputA2 = outputA3 = ventilation port  
1) Mounting option for padlocks; max. shackle Ø 8



## Dimensions in mm

A2	A3	B	C	D	E1	M
G 3/4	G 3/4	85	103	109	36	58
G 1	G 3/4	85	103	109	36	58

## Diagrams

### Flow rate characteristic

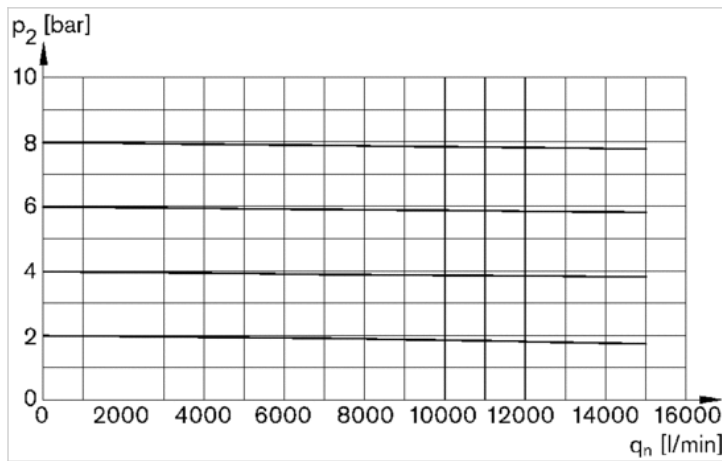

$p_2$  = secondary pressure  $q_n$  = nominal flow