







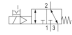

# 3/2-directional valve, Series CD04

- Qn = 900 l/min
- Pilot valve width : 26 mm
- NC NO
- Pipe connection
- Compressed air connection output : 1/8-27 PTF
- Electrical connection : Plug, EN 175301-803, form B, 3-pin
- Manual override : with detent
- With spring return
- Pilot : internal

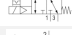

Version	Spool valve, positive overlapping
Activation	Electrically
Pilot	internal
Sealing principle	Soft sealing
Working pressure min./max.	3 ... 10 bar
Control pressure min./max.	3 ... 10 bar
Ambient temperature min./max.	-15 ... 50 °C
Medium temperature min./max.	-15 ... 50 °C
Medium	Compressed air
Max. particle size	50 µm
Oil content of compressed air	0 ... 1 mg/m <sup>3</sup>
Nominal flow Qn	900 l/min
Nominal flow 1 ► 2	900 l/min
Nominal flow 2 ► 3	900 l/min
Compressed air connection	according to ANSI B1.20.3
Connector standard	EN 175301-803:2006
Protection class with connection	IP65
Compatibility index	14
Duty cycle	100 %
Weight	See table below

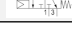
## Technical data

Part No.		MO	Compressed air connection	
			Input	
R412012695			1/8-27 PTF	
R412012696			1/8-27 PTF	
R412012698			1/8-27 PTF	
R412012700			1/8-27 PTF	

Part No.	Compressed air connection	
	Output	Exhaust
R412012695	1/8-27 PTF	1/8-27 PTF
R412012696	1/8-27 PTF	1/8-27 PTF
R412012698	1/8-27 PTF	1/8-27 PTF
R412012700	1/8-27 PTF	1/8-27 PTF

Part No.	Compressed air connection		Operationalvoltage	
	Pilot Exhaust		DC	AC 50 Hz
R412012695	M5		12 V	-
R412012696	M5		24 V	-
R412012698	M5		-	110 V
R412012700	M5		-	-

Part No.	Operationalvoltage		Voltage tolerance	
	AC 60 Hz	DC	AC 50 Hz	AC 60 Hz
R412012695	-	-10% / +10%	-	-
R412012696	-	-10% / +10%	-	-
R412012698	110 V	-	-20% / +10%	-10% / +20%
R412012700	-	-	-	-

Part No.	Power consumption		Holding power		Switch-on power
	DC	AC 50 Hz	AC 50 Hz	AC 60 Hz	AC 50 Hz
R412012695	4,6 W	-	-	-	-
R412012696	4,8 W	-	-	-	-
R412012698	-	8,3 VA	7,2 VA	7,2 VA	10,8 VA
R412012700	-	-	-	-	-

Nominal flow Qn at 6 bar and  $\Delta p = 1$  bar, MO = Manual override

## Technical information

The min. control pressure must be adhered to, since otherwise faulty switching and valve failure may result!  
The pressure dew point must be at least 15 °C under ambient and medium temperature and may not exceed 3 °C .  
The oil content of compressed air must remain constant during the life cycle.  
Use only the approved oils from AVENTICS. Further information can be found in the "Technical information" document (available in the MediaCentre).

option valve: The input and output compressed air connections can be exchanged. The valve can thereby be used in the NC or NO operating mode.

## Technical information

Material	
Housing	Die cast zinc Polyamide, fiber-glass reinforced
Seals	Acrylonitrile butadiene rubber

## Dimensions

### Dimensions in inches

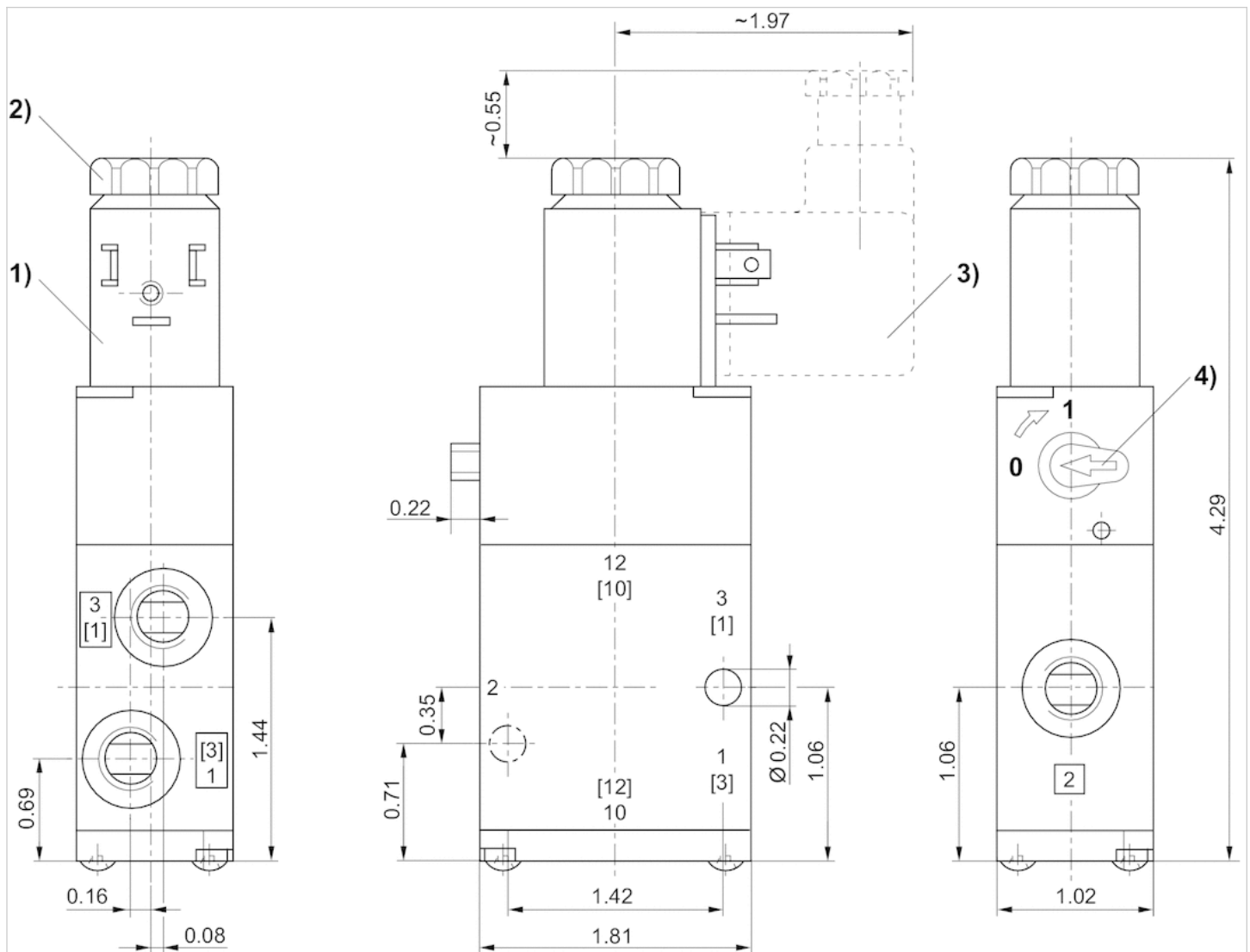

- 1) Coil can be rotated at 90° intervals
- 2) After removal of cap M5 internal thread
- 3) Valve plug connector can be plugged at 180° intervals
- 4) Manual override