

Tie rod cylinder ISO 15552, Series TRB

- Ø 32-125 mm
- Ports G 1/8 G 1/4 G 3/8 G 1/2
- double-acting
- with magnetic piston
- Cushioning Pneumatically adjustable
- Piston rod External thread
- Heat resistant

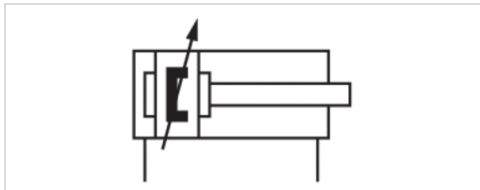

Standards	ISO 15552
Compressed air connection	Internal thread
Working pressure min./max.	1,5 ... 10 bar
Ambient temperature min./max.	-10 ... 120 °C
Medium temperature min./max.	-10 ... 120 °C
Medium	Compressed air
Max. particle size	50 µm
Oil content of compressed air	0 ... 5 mg/m ³
Pressure for determining piston forces	6.3 bar

Technical data

Piston Ø Piston rod thread Ports Piston rod Ø	32 mm M10x1,25 G 1/8 12 mm	40 mm M12x1,25 G 1/4 16 mm	50 mm M16x1,5 G 1/4 20 mm	63 mm M16x1,5 G 3/8 20 mm	80 mm M20x1,5 G 3/8 25 mm	100 mm M20x1,5 G 1/2 25 mm
Stroke 25	R412013636	R412013654	R412013674	R412013694	R412013712	R412013731
50	R412013637	R412013655	R412013675	R412013695	R412013713	R412013732
80	R412013638	R412013656	R412013676	R412013696	R412013714	R412013733
100	R412013639	R412013657	R412013677	R412013697	R412013715	R412013734
125	R412013640	R412013658	R412013678	R412013698	R412013716	R412013735
160	R412013641	R412013659	R412013679	R412013699	R412013717	R412013736
200	R412013642	R412013660	R412013680	R412013700	R412013718	R412013737
250	R412013643	R412013661	R412013681	R412013701	R412013719	R412013738
320	R412013644	R412013662	R412013682	R412013702	R412013720	R412013739
400	R412013645	R412013663	R412013683	R412013703	R412013721	R412013740
500	R412013646	R412013664	R412013684	R412013704	R412013722	R412013741

Piston Ø Piston rod thread Ports Piston rod Ø	125 mm M27x2 G 1/2 32 mm
Stroke 25	R480605348
50	R480605349
80	R480605350
100	R480605351
125	R480605352
160	R480605353
200	R480605354
250	R480605355
320	R480605356
400	R480605357
500	R480605358

Technical data

Piston Ø	32 mm	40 mm	50 mm	63 mm
Retracting piston force	435 N	660 N	1035 N	1765 N
Extracting piston force	505 N	790 N	1235 N	1960 N
Cushioning length	11,5 mm	15 mm	17 mm	16,5 mm
Cushioning energy	4,8 J	9 J	15 J	27 J
Weight 0 mm stroke	0,46 kg	0,67 kg	1,14 kg	1,4 kg
Weight +10 mm stroke	0,024 kg	0,03 kg	0,036 kg	0,052 kg
Tie-rods	Stainless steel	Stainless steel	Steel galvanized	Steel galvanized
Stroke max.	1600 mm	1900 mm	2100 mm	2500 mm

Piston Ø	80 mm	100 mm	125 mm
Retracting piston force	2855 N	4635 N	7220 N
Extracting piston force	3165 N	4945 N	7725 N
Cushioning length	19,5 mm	19,5 mm	22 mm
Cushioning energy	54 J	88 J	140 J
Weight 0 mm stroke	2,12 kg	3,16 kg	6,92 kg
Weight +10 mm stroke	0,06 kg	0,065 kg	0,21 kg
Tie-rods	Steel galvanized	Steel galvanized	Steel galvanized
Stroke max.	2800 mm	2800 mm	2750 mm

Technical information

The pressure dew point must be at least 15 °C under ambient and medium temperature and may not exceed 3 °C .

The oil content of compressed air must remain constant during the life cycle.

Use only the approved oils from AVENTICS. Further information can be found in the "Technical information" document (available in the MediaCentre).

Technical information

Material	
Cylinder tube	Aluminum, anodized
Piston rod	Stainless steel
Front cover	Die-cast aluminum
End cover	Die-cast aluminum
Seal	Fluorocaoutchouc
Nut for piston rod	Steel, galvanized
Scraper	Fluorocaoutchouc
Tie-rods	Stainless steel Steel, galvanized
See table for additional data on materials.	

Dimensions

Dimensions

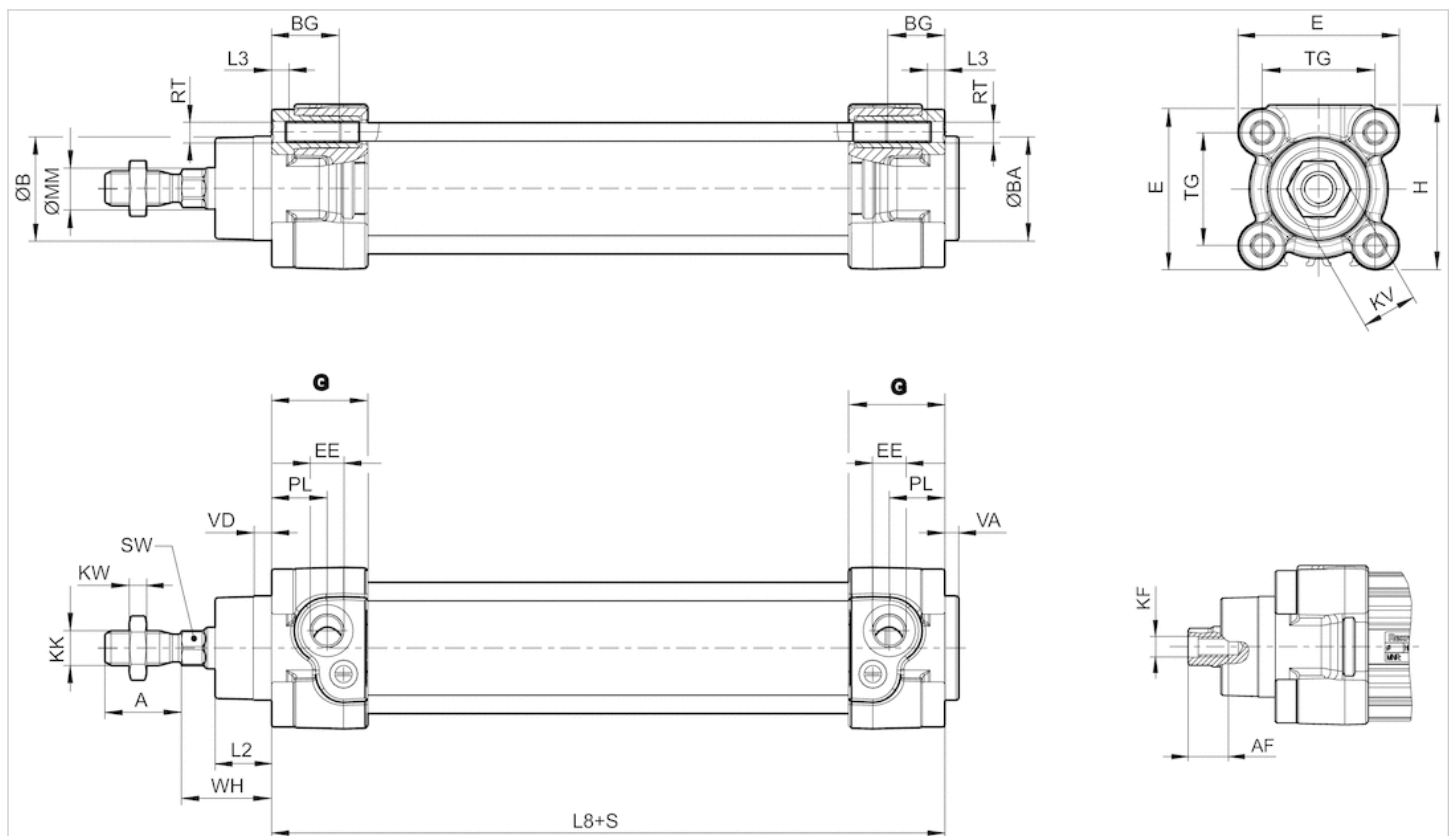

S = stroke

Dimensions

Piston Ø	A -2	AF+1	ØB d11	ØBA d11	BG min.	E	EE	G	H	KF	KK	KV	KW
32 mm	22	12	30	30	16	46.5	G 1/8	27.75	47.5	M6	M10x1,25	16	5
40 mm	24	13.5	35	35	16	53	G 1/4	33.25	53	M8	M12x1,25	18	6
50 mm	32	17	40	40	16	65	G 1/4	31	65	M10	M16x1,5	24	8
63 mm	32	17	45	45	16	75	G 3/8	38.25	75	M10	M16x1,5	24	8
80 mm	40	21	45	45	17	95	G 3/8	38.25	95	M12	M20x1,5	30	10
100 mm	40	21	55	55	17	115	G 1/2	42.25	115	M12	M20x1,5	30	10
125 mm	54	28	60	60	20	140	G 1/2	53.85	140	M16	M27x2	41	13.5

Piston Ø	ØMM f8	PL	L2	L3 ±0,5	L8	RT	SW	TG	VA -1	VD	WH
32 mm	12	16	16.25	4.5	94±0,4	M6	10	32,5±0,5	4	5	26±1,4
40 mm	16	20	18.25	4.5	105±0,7	M6	13	38±0,5	4	5	30±1,4
50 mm	20	19	25	4.5	106±0,7	M8	17	46,5±0,6	4	5	37±1,4
63 mm	20	24	25	4.5	121±0,8	M8	17	56,5±0,7	4	5	37±1,8
80 mm	25	23.5	33	0	128±0,8	M10	22	72±0,7	4	5	46±1,8
100 mm	25	25	36	0	138±1	M10	22	89±0,7	4	5	51±1,8
125 mm	32	33	45	0	160±1	M12	27	110±1,1	6	7	65±2,2

Diagrams

Cushioning diagram

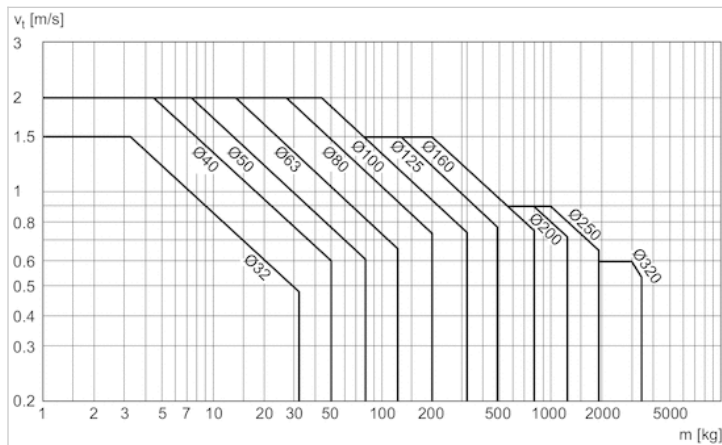

v = Piston velocity [m/s] m = Cushionable mass [kg]

Accessories overview

