

# QR1-S standard series

- Elbow fitting
- External thread
- G 1/8
- push-in fitting
- Ø 4
- QR1-S-RVT



Working pressure min./max.	-0,95 ... 10 bar
Ambient temperature min./max.	0 ... 60 °C
Weight	See table

## Technical data

Part No.	Port G	Port D	Delivery unit	Weight
2122004180	G 1/8	Ø 4	10 piece	0,012 kg
2122012380	G 3/8	Ø 12	10 piece	0,044 kg

## Technical information

The series QR1 (plastic) and QR2 (metal) can not be combined  
Thread seal with captive O-ring

For further information about assembling and tolerances of adaptable tubing can be found in the "Technical information" document (available in the MediaCentre).

## Technical information

Material	
Material	nickel-plated
Housing	Polybutyleneterephthalate
Seal	Acrylonitrile butadiene rubber
Tooth lock washer	Stainless steel
Release ring	Polyoxymethylene
Release ring holder	Die cast zinc Brass, nickel-plated
Thread	Brass, nickel-plated

## Dimensions

### Dimensions

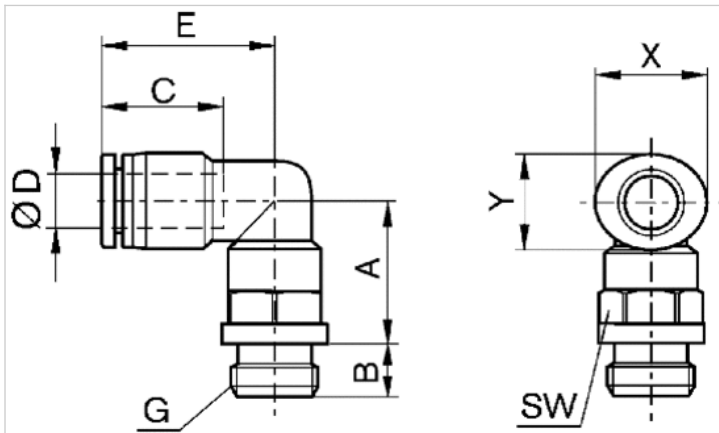

## Dimensions

Part No.	Port D	Port G	A	B	C	E	SW	X	Y
2122004180	Ø 4	G 1/8	9.5	5	16	18.5	13	12	10
2122012380	Ø 12	G 3/8	15.3	7	22.5	29.2	20	23	21