

QR1-S standard series

- Elbow screw fitting
- Internal thread
- G 1/8 G 1/4
- push-in fitting
- Ø 4 Ø 6 Ø 8 Ø 10
- QR1-S-RVI



Working pressure min./max.

-0,95 ... 10 bar

Ambient temperature min./max.

0 ... 60 °C

Weight

See table below

Technical data

| Part No. | Port G | Port D | Delivery unit | Weight |
|------------|--------|--------|---------------|----------|
| R412005129 | G 1/8 | Ø 4 | 10 piece | 0,016 kg |
| R412005130 | G 1/8 | Ø 6 | 10 piece | 0,016 kg |
| R412005131 | G 1/8 | Ø 8 | 10 piece | 0,023 kg |
| R412005132 | G 1/4 | Ø 4 | 10 piece | 0,019 kg |
| R412005133 | G 1/4 | Ø 6 | 10 piece | 0,022 kg |
| R412005134 | G 1/4 | Ø 8 | 10 piece | 0,025 kg |
| R412005135 | G 1/4 | Ø 10 | 10 piece | 0,036 kg |

Weight per piece

Technical information

The series QR1 (plastic) and QR2 (metal) can not be combined

For further information about assembling and tolerances of adaptable tubing can be found in the "Technical information" document (available in the MediaCentre).

Technical information

| Material | |
|----------|--------------------------------|
| Material | nickel-plated |
| Housing | Polybutyleneterephthalate |
| Seal | Acrylonitrile butadiene rubber |

| Material | |
|---------------------|------------------------------------|
| Tooth lock washer | Stainless steel |
| Release ring | Polyoxymethylene |
| Release ring holder | Die cast zinc Brass, nickel-plated |
| Thread | Brass, nickel-plated |

Dimensions

Dimensions

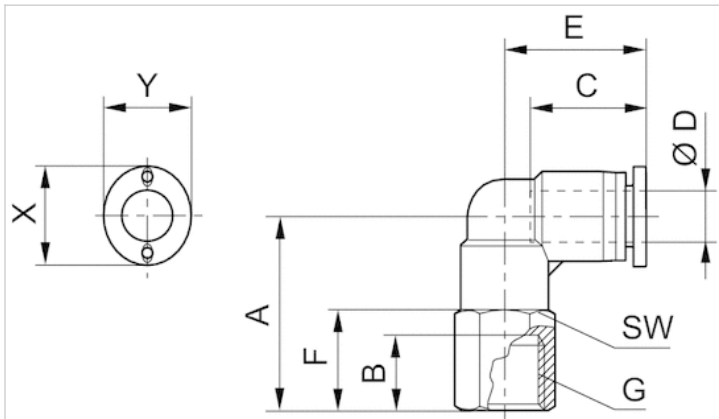

Dimensions

| Part No. | Port D | Port G | A | B | C | E | F | SW | X | Y |
|------------|--------|--------|----|----|------|------|----|----|----|----|
| R412005129 | Ø 4 | G 1/8 | 26 | 9 | 16 | 18.5 | 11 | 14 | 12 | 10 |
| R412005130 | Ø 6 | G 1/8 | 26 | 9 | 17 | 20.3 | 12 | 14 | 14 | 12 |
| R412005131 | Ø 8 | G 1/8 | 26 | 9 | 18.5 | 22.6 | 12 | 14 | 16 | 14 |
| R412005132 | Ø 4 | G 1/4 | 29 | 12 | 16 | 18.5 | 14 | 17 | 12 | 10 |
| R412005133 | Ø 6 | G 1/4 | 29 | 12 | 17 | 20.3 | 14 | 17 | 14 | 12 |
| R412005134 | Ø 8 | G 1/4 | 29 | 12 | 18.5 | 22.6 | 15 | 17 | 16 | 14 |
| R412005135 | Ø 10 | G 1/4 | 33 | 12 | 21 | 27 | 13 | 17 | 19 | 17 |