

QR1-S standard series

- 2x banjo union
- Uncollected
- G 1/8 G 1/4
- push-in fitting
- Ø 6 Ø 8 Ø 10
- QR1-S-RT1



Working pressure min./max.

-0,95 ... 10 bar

Ambient temperature min./max.

0 ... 60 °C

Weight

See table below

Technical data

Part No.	Port G	Port D	Delivery unit	Weight
R412000625	G 1/8	Ø 6	10 piece	0,006 kg
R412005306	G 1/8	Ø 8	10 piece	0,008 kg
R412000626	G 1/4	Ø 6	10 piece	0,006 kg
R412000622	G 1/4	Ø 8	10 piece	0,009 kg
R412005308	G 1/4	Ø 10	10 piece	0,013 kg

Weight per piece

Technical information

The series QR1 (plastic) and QR2 (metal) can not be combined

For further information about assembling and tolerances of adaptable tubing can be found in the "Technical information" document (available in the MediaCentre).

Technical information

Material	
Material	nickel-plated
Housing	Polybutyleneterephthalate
Seal	Acrylonitrile butadiene rubber
Tooth lock washer	Stainless steel
Release ring	Polyoxymethylene

Material	
Release ring holder	Die cast zinc Brass, nickel-plated

Dimensions

Dimensions

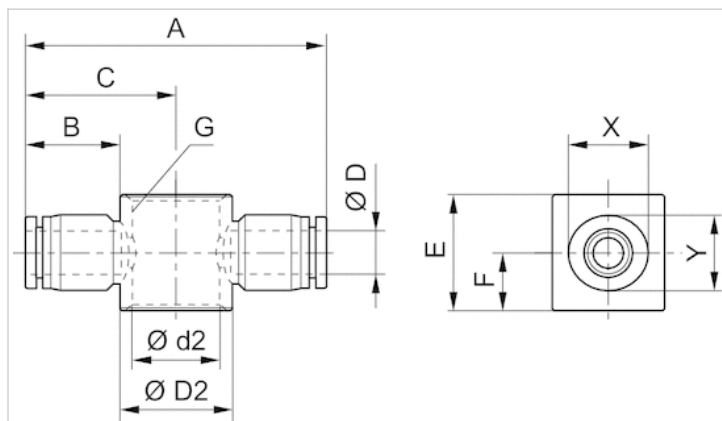

Dimensions

Part No.	Port D	Port G	A	B	C	$\varnothing D2$	$\varnothing d2$	E	F	X	Y
R412000625	$\varnothing 6$	G 1/8	39.9	17	19.8	15	9.8	17	8.5	14	12
R412005306	$\varnothing 8$	G 1/8	43.2	18.5	21.6	15	9.8	17	8.5	16	14
R412000626	$\varnothing 6$	G 1/4	41.8	19	20.9	18	13.2	19	9.5	14	12
R412000622	$\varnothing 8$	G 1/4	43.2	18.5	21.9	18	13.2	19	9.5	16	14
R412005308	$\varnothing 10$	G 1/4	48	21	24	18	13.2	19	9.5	19	17