

QR1-S standard series

- T-union
- External thread
- M5 G 1/8 G 1/4 G 3/8 G 1/2
- push-in fitting
- Ø 4 Ø 6 Ø 8 Ø 10 Ø 12 Ø 14 Ø 16
- QR1-S-RTT



Working pressure min./max.	-0,95 ... 10 bar
Ambient temperature min./max.	0 ... 60 °C
Weight	See table below

Technical data

Part No.	Port G	Port D	Delivery unit	Weight
2122204050	M5	Ø 4	10 piece	0,011 kg
R412005201	M5	Ø 6	10 piece	0,014 kg
2122204180	G 1/8	Ø 4	10 piece	0,014 kg
2122206180	G 1/8	Ø 6	10 piece	0,015 kg
2122208180	G 1/8	Ø 8	10 piece	0,019 kg
R412005205	G 1/8	Ø 10	10 piece	0,035 kg
2122204140	G 1/4	Ø 4	10 piece	0,019 kg
2122206140	G 1/4	Ø 6	10 piece	0,022 kg
2122208140	G 1/4	Ø 8	10 piece	0,027 kg
2122210140	G 1/4	Ø 10	10 piece	0,035 kg
R412005206	G 1/4	Ø 12	10 piece	0,05 kg
R412005203	G 3/8	Ø 6	10 piece	0,034 kg
2122208380	G 3/8	Ø 8	10 piece	0,034 kg
2122210380	G 3/8	Ø 10	10 piece	0,036 kg
2122212380	G 3/8	Ø 12	10 piece	0,052 kg
2122214380	G 3/8	Ø 14	10 piece	0,051 kg
2122210120	G 1/2	Ø 10	10 piece	0,057 kg
2122212120	G 1/2	Ø 12	5 piece	0,052 kg
2122214120	G 1/2	Ø 14	5 piece	0,05 kg
R412005209	G 1/2	Ø 16	5 piece	0,114 kg

Weight per piece

Technical information

The series QR1 (plastic) and QR2 (metal) can not be combined

Thread seal with captive O-ring

For further information about assembling and tolerances of adaptable tubing can be found in the "Technical information" document (available in the MediaCentre).

Technical information

Material	
Material	nickel-plated
Housing	Polybutyleneterephthalate
Seal	Acrylonitrile butadiene rubber
Tooth lock washer	Stainless steel
Release ring	Polyoxymethylene
Release ring holder	Die cast zinc Brass, nickel-plated
Thread	Brass, nickel-plated

Dimensions

Dimensions

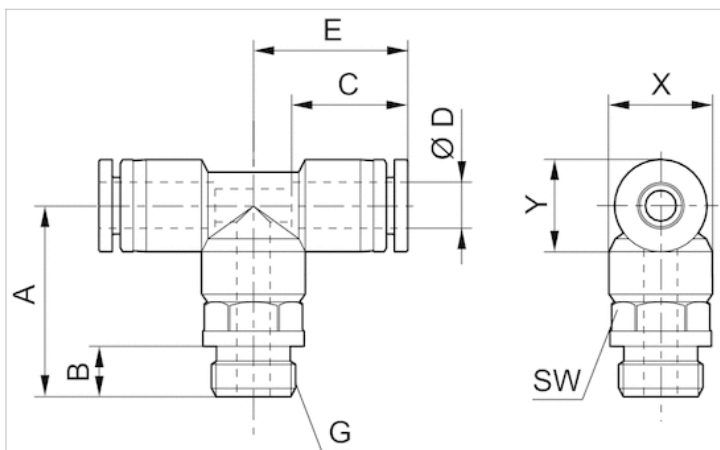

Dimensions

Part No.	Port D	Port G	A	B	C	E	SW	X	Y
2122204050	Ø 4	M5	20.5	4	16	18.3	10	12	10
R412005201	Ø 6	M5	21.5	5	17	20.4	12	14	12
2122204180	Ø 4	G 1/8	21.6	5	16	18.1	10	12	10
2122206180	Ø 6	G 1/8	21.9	5	17	20.4	12	14	12
2122208180	Ø 8	G 1/8	22.5	5	18.5	22.7	14	16	14
R412005205	Ø 10	G 1/8	29	5	21	26.1	17	19	17
2122204140	Ø 4	G 1/4	22.6	6	16	18.1	17	12	10
2122206140	Ø 6	G 1/4	23.9	6	17	20.4	17	14	12
2122208140	Ø 8	G 1/4	24.5	6	18.5	22.7	17	16	14

UK Office
5 Caulside Drive
Antrim
BT41 2DU
United Kingdom
+44 (0) 28 9448 1808

European Office
Unit 6, Saint Anthony's Business Park
Dublin
D22 VW95
Ireland
+353 (0) 1 4373653



Part No.	Port D	Port G	A	B	C	E	SW	X	Y
2122210140	Ø 10	G 1/4	30	6	21	26.1	17	19	17
R412005206	Ø 12	G 1/4	32	6	22.5	29.3	21	23	21
R412005203	Ø 6	G 3/8	25.9	7	17	20.4	20	14	12
2122208380	Ø 8	G 3/8	25.8	7	18.5	22.7	20	16	14
2122210380	Ø 10	G 3/8	31	7	21	26.1	20	19	17
2122212380	Ø 12	G 3/8	33	7	22.5	29.3	21	23	21
2122214380	Ø 14	G 3/8	30.1	7	24.6	32.1	20	25	23
2122210120	Ø 10	G 1/2	32.5	8.5	21	26.1	24	19	17
2122212120	Ø 12	G 1/2	34.5	8.5	22.5	29.3	24	23	21
2122214120	Ø 14	G 1/2	25.6	8.5	24.6	32.1	24	25	23
R412005209	Ø16	G 1/2	40.8	8.5	24.8	33.3	24	27	24