

QR1-S standard series

- Straight plug connector
- push-in fitting
- Ø 4 Ø 6 Ø 8 Ø 10 Ø 12 Ø 14 Ø 16
- push-in fitting
- Ø 4 Ø 6 Ø 8 Ø 10 Ø 12 Ø 14 Ø 16
- QR1-S-RSK



Working pressure min./max.	-0,95 ... 10 bar
Ambient temperature min./max.	0 ... 60 °C
Weight	See table below

Technical data

Part No.	Port G	Port D	Delivery unit	Weight
2121504000	Ø 4	Ø 4	10 piece	0,004 kg
2121506000	Ø 6	Ø 6	10 piece	0,006 kg
2121508000	Ø 8	Ø 8	10 piece	0,008 kg
2121510000	Ø 10	Ø 10	10 piece	0,013 kg
2121512000	Ø 12	Ø 12	10 piece	0,019 kg
2121514000	Ø 14	Ø 14	5 piece	0,025 kg
R412005059	Ø 16	Ø 16	5 piece	0,035 kg

Weight per piece

Technical information

The series QR1 (plastic) and QR2 (metal) can not be combined

For further information about assembling and tolerances of adaptable tubing can be found in the "Technical information" document (available in the MediaCentre).

Technical information

Material	
Material	nickel-plated
Housing	Polybutyleneterephthalate
Seal	Acrylonitrile butadiene rubber

UK Office
5 Caulside Drive
Antrim
BT41 2DU
United Kingdom
+44 (0) 28 9448 1808

European Office
Unit 6, Saint Anthony's Business Park
Dublin
D22 VW95
Ireland
+353 (0) 1 4373653



Material	
Tooth lock washer	Stainless steel
Release ring	Polyoxymethylene
Release ring holder	Die cast zinc Brass, nickel-plated

Dimensions

Dimensions

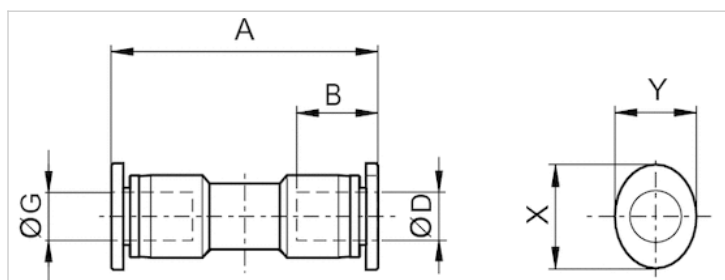

Dimensions

Part No.	Port D	Port G	A	B	X	Y
2121504000	Ø 4	Ø 4	33.4	16	12	10
2121506000	Ø 6	Ø 6	35.4	17	14	12
2121508000	Ø 8	Ø 8	39	18.5	16	14
2121510000	Ø 10	Ø 10	43	21	19	17
2121512000	Ø 12	Ø 12	47	22.5	23	21
2121514000	Ø 14	Ø 14	51.2	24.6	25	23
R412005059	Ø16	Ø16	62.2	24.8	27	24