

# QR1-S standard series

- Straight plug connector, reducing
- push-in fitting
- Ø 6 Ø 8 Ø 10 Ø 12 Ø 16
- push-in fitting
- Ø 4 Ø 6 Ø 8 Ø 10 Ø 12
- QR1-S-RSR



Working pressure min./max.

-0,95 ... 10 bar

Ambient temperature min./max.

0 ... 60 °C

Weight

See table below

## Technical data

Part No.	Port G	Port D	Delivery unit	Weight
R412005060	Ø 6	Ø 4	10 piece	0,005 kg
R412005061	Ø 8	Ø 4	10 piece	0,013 kg
R412005062	Ø 8	Ø 6	10 piece	0,007 kg
R412005063	Ø 10	Ø 6	10 piece	0,02 kg
R412005064	Ø 10	Ø 8	10 piece	0,011 kg
R412005065	Ø 12	Ø 8	10 piece	0,029 kg
R412005066	Ø 12	Ø 10	10 piece	0,016 kg
R412005067	Ø 16	Ø 12	5 piece	0,027 kg

Weight per piece

## Technical information

The series QR1 (plastic) and QR2 (metal) can not be combined

For further information about assembling and tolerances of adaptable tubing can be found in the "Technical information" document (available in the MediaCentre).

## Technical information

Material	
Material	nickel-plated
Housing	Polybutyleneterephthalate
Seal	Acrylonitrile butadiene rubber

Material	
Tooth lock washer	Stainless steel
Release ring	Polyoxymethylene
Release ring holder	Die cast zinc Brass, nickel-plated

## Dimensions

### Dimensions

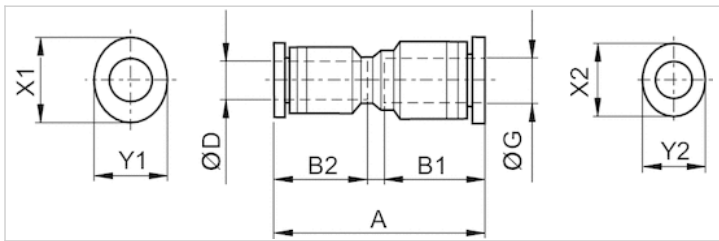

### Dimensions

Part No.	Port D	Port G	A	B1	B2	X1	X2	Y1	Y2
R412005060	Ø 4	Ø 6	34.9	17	16	14	12	12	10
R412005061	Ø 4	Ø 8	37.2	18.5	17	16	12	14	10
R412005062	Ø 6	Ø 8	38.5	18.5	17	16	14	14	12
R412005063	Ø 6	Ø 10	41	21	18.5	19	14	17	12
R412005064	Ø 8	Ø 10	41	21	18.5	19	16	17	14
R412005065	Ø 8	Ø 12	45	22.5	21	23	16	21	14
R412005066	Ø 10	Ø 12	45	22.5	21	23	19	21	17
R412005067	Ø 12	Ø 16	51.8	24.8	22.5	27	23	24	21