

QR1-S standard series

- Swivel banjo connection 3-fold, double
- External thread
- G 1/8 G 1/4 G 3/8
- push-in fitting
- Ø 4 Ø 6 Ø 8 Ø 10
- QR1-S-RW6



Working pressure min./max.	-0,95 ... 10 bar
Ambient temperature min./max.	0 ... 60 °C
Weight	See table below

Technical data

Part No.	Port G	Port D	Delivery unit	Weight
R412005186	G 1/8	Ø 4	10 piece	0,044 kg
R412005187	G 1/8	Ø 6	10 piece	0,05 kg
R412005189	G 1/4	Ø 4	10 piece	0,046 kg
R412005190	G 1/4	Ø 6	10 piece	0,052 kg
R412005191	G 1/4	Ø 8	10 piece	0,074 kg
R412005194	G 3/8	Ø 6	10 piece	0,062 kg
R412005195	G 3/8	Ø 8	10 piece	0,079 kg
R412005196	G 3/8	Ø 10	5 piece	0,134 kg

Weight per piece

Technical information

The series QR1 (plastic) and QR2 (metal) can not be combined
Thread seal with captive O-ring

For further information about assembling and tolerances of adaptable tubing can be found in the "Technical information" document (available in the MediaCentre).

Technical information

Material	
Material	nickel-plated
Housing	Polybutyleneterephthalate

Material	
Seal	Acrylonitrile butadiene rubber
Tooth lock washer	Stainless steel
Release ring	Polyoxymethylene
Release ring holder	Die cast zinc Brass, nickel-plated
Thread	Brass, nickel-plated

Dimensions

Dimensions

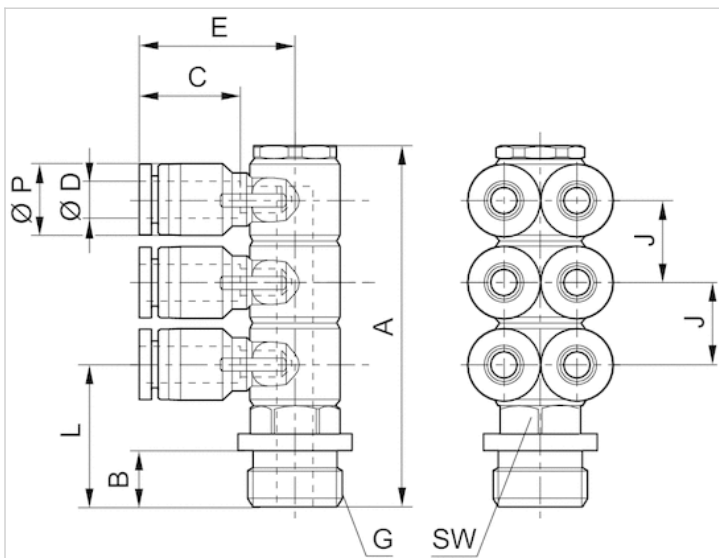

Dimensions

Part No.	Port D	Port G	A	B	C	E	J	L	Ø P	SW
R412005186	Ø 4	G 1/8	55.2	5	16	22.3	14	15.6	10.4	14
R412005187	Ø 6	G 1/8	55.2	5	17	26.5	14	15.6	12.4	14
R412005189	Ø 4	G 1/4	57.2	6	16	22.3	14	16	10.4	17
R412005190	Ø 6	G 1/4	57.2	6	17	26.5	14	16	12.4	17
R412005191	Ø 8	G 1/4	60.3	6	18.5	29.1	15	16.5	14.4	17
R412005194	Ø 6	G 3/8	58.2	7	17	26.5	14	15.5	12.4	21
R412005195	Ø 8	G 3/8	61.3	7	18.5	29.1	15	16	14.4	21
R412005196	Ø 10	G 3/8	72.2	7	21	34.3	18	20.8	17.6	21