

QR1-S standard series

- Push-in connector
- External thread
- M5 G 1/8 G 1/4 G 3/8 G 1/2
- pin bushing
- Ø 4 Ø 6 Ø 8 Ø 10 Ø 12 Ø 14 Ø 16
- QR1-S-RAS



Working pressure min./max.

-0,95 ... 10 bar

Ambient temperature min./max.

0 ... 60 °C

Weight

See table below

Technical data

Part No.	Port G	Port D	Delivery unit	Weight
2121604050	M5	Ø 4	10 piece	0,006 kg
R412005068	M5	Ø 6	10 piece	0,006 kg
2121604180	G 1/8	Ø 4	10 piece	0,006 kg
2121606180	G 1/8	Ø 6	10 piece	0,012 kg
R412005071	G 1/8	Ø 8	10 piece	0,012 kg
2121606140	G 1/4	Ø 6	10 piece	0,015 kg
2121608140	G 1/4	Ø 8	10 piece	0,013 kg
R412005072	G 1/4	Ø 10	10 piece	0,024 kg
R412005073	G 1/4	Ø 12	10 piece	0,029 kg
2121610380	G 3/8	Ø 10	10 piece	0,025 kg
R412005074	G 3/8	Ø 12	10 piece	0,034 kg
2121610120	G 1/2	Ø 10	10 piece	0,034 kg
2121612120	G 1/2	Ø 12	10 piece	0,04 kg
R412005076	G 1/2	Ø 14	5 piece	0,025 kg
R412005078	G 1/2	Ø 16	5 piece	0,051 kg

Weight per piece

Technical information

The series QR1 (plastic) and QR2 (metal) can not be combined
Thread seal with captive O-ring

For further information about assembling and tolerances of adaptable tubing can be found in the "Technical information" document (available in the MediaCentre).

Technical information

Material	
Material	nickel-plated
Housing	Polybutyleneterephthalate
Seal	Acrylonitrile butadiene rubber
Thread	Brass, nickel-plated

Dimensions

Dimensions

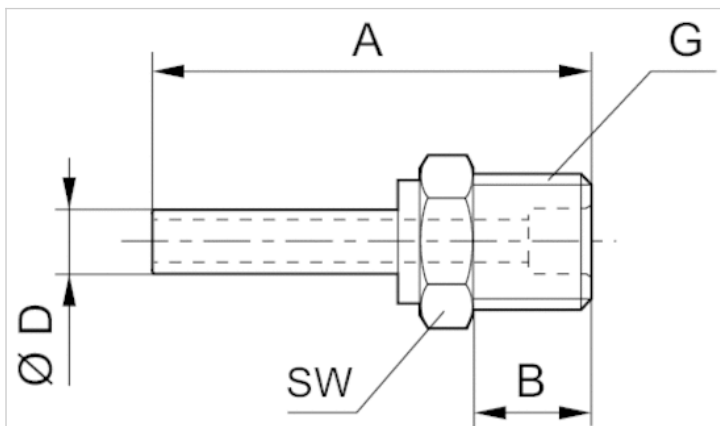

Dimensions

Part No.	Port D	Port G	A	B	SW
2121604050	Ø 4	M5	36.9	4	10
R412005068	Ø 6	M5	41.9	4	10
2121604180	Ø 4	G 1/8	30	5	10
2121606180	Ø 6	G 1/8	45	5	10
R412005071	Ø 8	G 1/8	45	5	12
2121606140	Ø 6	G 1/4	36	6	14
2121608140	Ø 8	G 1/4	38	6	14
R412005072	Ø 10	G 1/4	50	6	17
R412005073	Ø 12	G 1/4	57	6	19
2121610380	Ø 10	G 3/8	44	7	17
R412005074	Ø 12	G 3/8	53	7	19
2121610120	Ø 10	G 1/2	46	8.5	21
2121612120	Ø 12	G 1/2	51	8.5	21
R412005076	Ø 14	G 1/2	52.5	8.5	24
R412005078	Ø 16	G 1/2	61	8.5	21