

# QR1-S standard series

- Push-in connector
- External thread
- 10-32 UNF 3/8 NPT 1/8 NPT 1/4 NPT 1/2 NPT
- pin bushing
- Ø5/32 Ø1/4 Ø1/2 Ø3/8 Ø5/16
- QR1-S-RAS



Working pressure min./max.

-0,95 ... 10 bar

Ambient temperature min./max.

0 ... 60 °C

Weight

See table below

## Technical data

Part No.	Port G	Port D	Delivery unit	Weight
R432000045	10-32 UNF	Ø5/32	10 piece	0,005 kg
R432000034	10-32 UNF	Ø1/4	10 piece	0,014 kg
R432000033	3/8 NPT	Ø1/2	10 piece	0,03 kg
R432000037	3/8 NPT	Ø1/4	10 piece	0,023 kg
R432000040	3/8 NPT	Ø3/8	10 piece	0,027 kg
R432000044	3/8 NPT	Ø5/16	10 piece	0,032 kg
R432000047	1/8 NPT	Ø5/32	10 piece	0,005 kg
R432000036	1/8 NPT	Ø1/4	10 piece	0,018 kg
R432000032	1/4 NPT	Ø1/2	10 piece	0,032 kg
R432000035	1/4 NPT	Ø1/4	10 piece	0,023 kg
R432000039	1/4 NPT	Ø3/8	10 piece	0,023 kg
R432000046	1/4 NPT	Ø5/32	10 piece	0,014 kg
R432000042	1/4 NPT	Ø5/16	10 piece	0,027 kg
R432000038	1/2 NPT	Ø3/8	10 piece	0,03 kg
R432000031	1/2 NPT	Ø1/2	5 piece	0,05 kg

Weight per piece

## Technical information

The series QR1 (plastic) and QR2 (metal) can not be combined

Thread seal with captive O-ring

These pneumatic components with NPT or inch thread dimensions are only available from our US sales organization.

For further information about assembling and tolerances of adaptable tubing can be found in the "Technical information" document (available in the MediaCentre).

## Technical information

Material	
Material	nickel-plated
Housing	Polybutyleneterephthalate
Seal	Acrylonitrile butadiene rubber
Thread	Brass, nickel-plated

## Dimensions

### Dimensions in inches

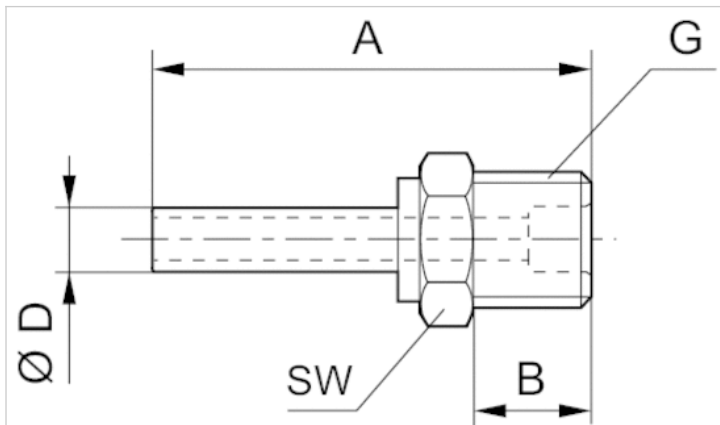

### Dimensions in inches

Part No.	Port D	Port G	A	B	SW
R432000045	Ø5/32	10-32 UNF	1.45	0.16	3/8
R432000034	Ø1/4	10-32 UNF	1.65	0.16	3/8
R432000033	Ø1/2	3/8 NPT	2.4	0.47	23/32
R432000037	Ø1/4	3/8 NPT	1.65	0.47	11/16
R432000040	Ø3/8	3/8 NPT	1.93	0.47	11/16
R432000044	Ø5/16	3/8 NPT	1.73	0.47	11/16
R432000047	Ø5/32	1/8 NPT	1.3	0.32	13/32
R432000036	Ø1/4	1/8 NPT	1.5	0.32	13/32
R432000032	Ø1/2	1/4 NPT	2.44	0.43	23/32
R432000035	Ø1/4	1/4 NPT	1.62	0.43	9/16
R432000039	Ø3/8	1/4 NPT	2.17	0.43	19/32
R432000046	Ø5/32	1/4 NPT	1.42	0.43	9/16
R432000042	Ø5/16	1/4 NPT	1.7	0.43	9/16
R432000038	Ø3/8	1/2 NPT	2.05	0.59	27/32
R432000031	Ø1/2	1/2 NPT	2.25	0.59	27/32