

# QR1-S standard series

- Elbow screw fitting
- Internal thread
- 10-32 UNF 3/8 NPT 1/8 NPT 1/4 NPT 1/2 NPT
- push-in fitting
- Ø1/4 Ø5/32 Ø3/8 Ø5/16
- QR1-S-RVI



Working pressure min./max.

-0,95 ... 10 bar

Ambient temperature min./max.

0 ... 60 °C

Weight

See table below

## Technical data

Part No.	Port G	Port D	Delivery unit	Weight
R432000194	10-32 UNF	Ø1/4	10 piece	-
R432000204	10-32 UNF	Ø5/32	10 piece	0,009 kg
R432000197	3/8 NPT	Ø1/4	10 piece	0,027 kg
R432000200	3/8 NPT	Ø3/8	10 piece	0,027 kg
R432000203	3/8 NPT	Ø5/16	10 piece	0,032 kg
R432000196	1/8 NPT	Ø1/4	10 piece	-
R432000202	1/8 NPT	Ø5/16	10 piece	0,009 kg
R432000206	1/8 NPT	Ø5/32	10 piece	0,018 kg
R432000195	1/4 NPT	Ø1/4	10 piece	0,018 kg
R432000199	1/4 NPT	Ø3/8	10 piece	0,023 kg
R432000201	1/4 NPT	Ø5/16	10 piece	0,009 kg
R432000205	1/4 NPT	Ø5/32	10 piece	0,023 kg
R432000198	1/2 NPT	Ø3/8	10 piece	0,032 kg

Weight per piece

## Technical information

The series QR1 (plastic) and QR2 (metal) can not be combined

These pneumatic components with NPT or inch thread dimensions are only available from our US sales organization.

For further information about assembling and tolerances of adaptable tubing can be found in the "Technical information" document (available in the MediaCentre).

## Technical information

### Material

Material	nickel-plated
Housing	Polybutyleneterephthalate
Seal	Acrylonitrile butadiene rubber
Tooth lock washer	Stainless steel
Release ring	Polyoxymethylene
Release ring holder	Die cast zinc Brass, nickel-plated
Thread	Brass, nickel-plated

## Dimensions

### Dimensions in inches

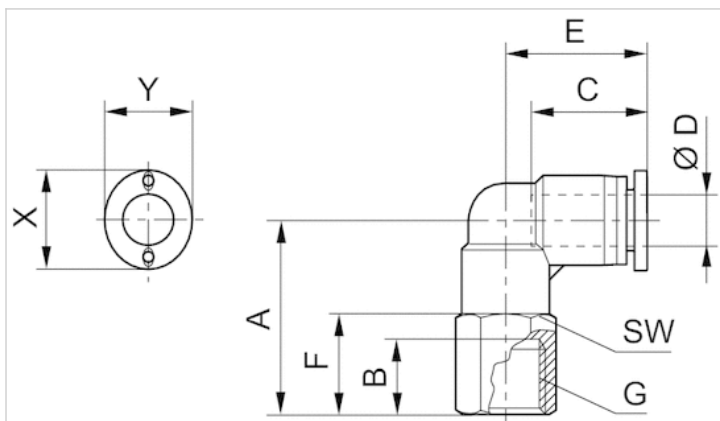

### Dimensions in inches

Part No.	Port D	Port G	A	B	C	E	F	SW	X	Y
R432000194	Ø1/4	10-32 UNF	0.63	0.2	0.67	0.8	0.32	7/16	0.55	0.47
R432000204	Ø5/32	10-32 UNF	0.63	0.2	0.63	0.73	0.32	7/16	0.47	0.39
R432000197	Ø1/4	3/8 NPT	1.02	0.47	0.67	0.8	0.63	7/8	0.55	0.47
R432000200	Ø3/8	3/8 NPT	1.36	0.51	0.83	1.06	0.83	7/8	0.75	0.67
R432000203	Ø5/16	3/8 NPT	1.18	0.51	0.73	0.89	0.59	7/8	0.63	0.55
R432000196	Ø1/4	1/8 NPT	0.67	0.24	0.67	0.8	0.47	9/16	0.55	0.47
R432000202	Ø5/16	1/8 NPT	1.02	0.36	0.73	0.89	0.47	9/16	0.63	0.55
R432000206	Ø5/32	1/8 NPT	0.67	0.24	0.63	0.73	0.43	9/16	0.47	0.39
R432000195	Ø1/4	1/4 NPT	0.91	0.36	0.67	0.8	0.55	11/16	0.55	0.47
R432000199	Ø3/8	1/4 NPT	1.3	0.47	0.83	1.06	0.51	11/16	0.75	0.67
R432000201	Ø5/16	1/4 NPT	1.14	0.47	0.73	0.89	0.59	11/16	0.63	0.55
R432000205	Ø5/32	1/4 NPT	0.93	0.36	0.63	0.73	0.55	11/16	0.47	0.39
R432000198	Ø3/8	1/2 NPT	1.5	0.63	0.83	1.06	0.89	7/8	0.75	0.67