

QR1-S standard series

- Straight plug connector, reducing
- push-in fitting
- Ø5/32 Ø5/16 Ø1/4 Ø1/2
- push-in fitting
- Ø1/4 Ø3/8 Ø5/16
- QR1-S-RSR



Working pressure min./max.

-0,95 ... 10 bar

Ambient temperature min./max.

0 ... 60 °C

Weight

See table below

Technical data

Part No.	Port G	Port D	Delivery unit	Weight
R432000162	Ø5/32	Ø1/4	10 piece	0,005 kg
R432000163	Ø5/16	Ø3/8	10 piece	0,009 kg
R432000164	Ø1/4	Ø5/16	10 piece	0,005 kg
R432000161	Ø1/4	Ø3/8	10 piece	0,032 kg
R432000160	Ø1/2	Ø3/8	10 piece	0,018 kg

Weight per piece

Technical information

The series QR1 (plastic) and QR2 (metal) can not be combined

These pneumatic components with NPT or inch thread dimensions are only available from our US sales organization.

For further information about assembling and tolerances of adaptable tubing can be found in the "Technical information" document (available in the MediaCentre).

Technical information

Material	
Material	nickel-plated
Housing	Polybutyleneterephthalate
Seal	Acrylonitrile butadiene rubber
Tooth lock washer	Stainless steel

Material	
Release ring	Polyoxymethylene
Release ring holder	Die cast zinc Brass, nickel-plated

Dimensions

Dimensions in inches

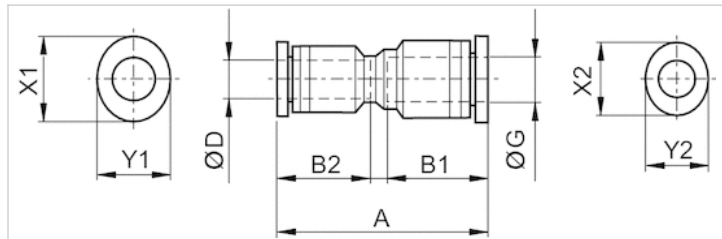

Dimensions in inches

Part No.	Port D	Port G	A	B1	B2	X1	Y1	X2	Y2
R432000162	Ø1/4	Ø5/32	1.41	0.71	0.63	0.552	0.473	0.473	0.39
R432000163	Ø3/8	Ø5/16	1.68	0.83	0.73	0.749	0.67	0.63	0.55
R432000164	Ø5/16	Ø1/4	1.53	0.73	0.67	0.63	0.552	0.552	0.47
R432000161	Ø3/8	Ø1/4	1.69	0.83	0.76	0.749	0.552	0.552	0.47
R432000160	Ø3/8	Ø1/2	1.83	0.88	0.83	0.906	0.827	0.749	0.67