

Series QR2-S, standard

- T-plug connector
- push-in fitting
- Ø 4 Ø 5 Ø 6 Ø 8 Ø 10 Ø 12 Ø 14 Ø 16
- push-in fitting
- Ø 4 Ø 5 Ø 6 Ø 8 Ø 10 Ø 12 Ø 14 Ø 16
- QR2-S-RTK



Working pressure min./max.

-0,95 ... 16 bar

Ambient temperature min./max.

-20 ... 80 °C

Weight

See table below

Technical data

Part No.	Port G	Port D	Delivery unit	Weight
1823381043	Ø 4	Ø 4	10 piece	0,015 kg
1823381044	Ø 5	Ø 5	10 piece	0,016 kg
1823381045	Ø 6	Ø 6	10 piece	0,019 kg
1823381046	Ø 8	Ø 8	10 piece	0,027 kg
1823381047	Ø 10	Ø 10	10 piece	0,038 kg
1823381048	Ø 12	Ø 12	5 piece	0,051 kg
1823381049	Ø 14	Ø 14	5 piece	0,076 kg
R412010541	Ø 16	Ø 16	1 piece	0,115 kg

Weight per piece

Technical information

The series QR1 (plastic) and QR2 (metal) can not be combined

For further information about assembling and tolerances of adaptable tubing can be found in the "Technical information" document (available in the MediaCentre).

Technical information

Material	
Housing	Brass, nickel-plated
Seal	Acrylonitrile butadiene rubber
Tooth lock washer	Stainless steel

Material	
Release ring	Brass, nickel-plated

Dimensions

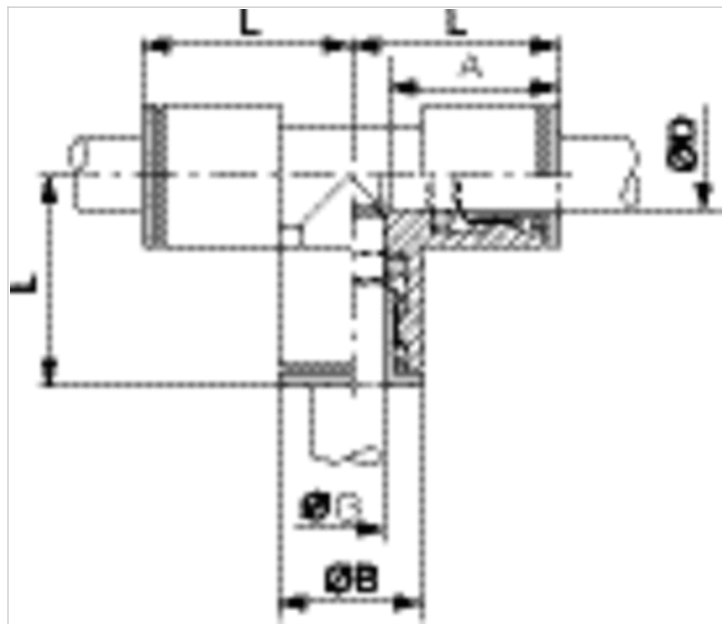

Dimensions

Part No.	Port D	Port G	ØB	L	A*
1823381043	Ø 4	Ø 4	9	17.5	15
1823381044	Ø 5	Ø 5	10	19	16
1823381045	Ø 6	Ø 6	11	19.5	16
1823381046	Ø 8	Ø 8	13	23	18
1823381047	Ø 10	Ø 10	15	25	15
1823381048	Ø 12	Ø 12	17	27	20
1823381049	Ø 14	Ø 14	20	30	22
R412010541	Ø16	Ø16	23	36	25

*