

Series QR2-S, standard

- Y - Plug connection
- push-in fitting
- Ø 4 Ø 6 Ø 8 Ø 10
- push-in fitting
- Ø 4 Ø 6 Ø 8 Ø 10
- QR2-S-RYK



Working pressure min./max.

-0,95 ... 15 bar

Ambient temperature min./max.

-20 ... 70 °C

Weight

See table below

Technical data

Part No.	Port G	Port D	Delivery unit	Weight
R412010804	Ø 4	Ø 4	5 piece	0,014 kg
R412010802	Ø 6	Ø 6	5 piece	0,034 kg
R412010117	Ø 8	Ø 8	5 piece	0,044 kg
R412010535	Ø 10	Ø 10	5 piece	0,062 kg

Weight per piece

Technical information

The series QR1 (plastic) and QR2 (metal) can not be combined

For further information about assembling and tolerances of adaptable tubing can be found in the "Technical information" document (available in the MediaCentre).

Technical information

Material	
Housing	Brass, nickel-plated
Seal	Acrylonitrile butadiene rubber
Release ring	Brass, nickel-plated

Dimensions

Dimensions

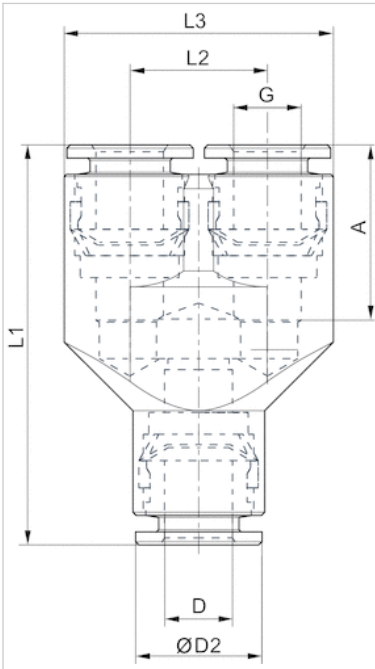

Dimensions

Part No.	Port D	Port G	A*	ØD2	L1	L2	L3
R412010804	Ø 4	Ø 4	12.5	9	29.5	9.5	18.5
R412010802	Ø 6	Ø 6	15.5	11.5	36	12.5	24.5
R412010117	Ø 8	Ø 8	15.5	13.5	37.5	14.5	28.5
R412010535	Ø 10	Ø 10	17.5	15.5	44	16.5	32.5

*