

Series QR2-C, stainless steel

- T-union
- External thread
- M5
- push-in fitting
- Ø 4
- QR2-C-RTT
- suitable for use in food processing



Working pressure min./max.	-0,95 ... 16 bar
Ambient temperature min./max.	-20 ... 150 °C
Weight	See table

Technical data

Part No.	Port G	Port D	Delivery unit	Weight
R412004889	M5	Ø 4	2 piece	0,013 kg
R412004904	G 1/8	Ø 4	2 piece	0,017 kg
R412004905	G 1/8	Ø 6	2 piece	0,029 kg
R412004906	G 1/8	Ø 8	2 piece	0,03 kg
R412004907	G 1/4	Ø 6	2 piece	0,033 kg
R412004908	G 1/4	Ø 8	2 piece	0,035 kg

Technical information

The series QR1 (plastic) and QR2 (metal) can not be combined
Thread seal with captive O-ring

For further information about assembling and tolerances of adaptable tubing can be found in the "Technical information" document (available in the MediaCentre).

Technical information

Material	
Housing	Stainless steel
Seal	Fluorocaoutchouc
Tooth lock washer	Stainless steel
Release ring	Stainless steel

Material	
Thread	Stainless steel

Dimensions

Dimensions

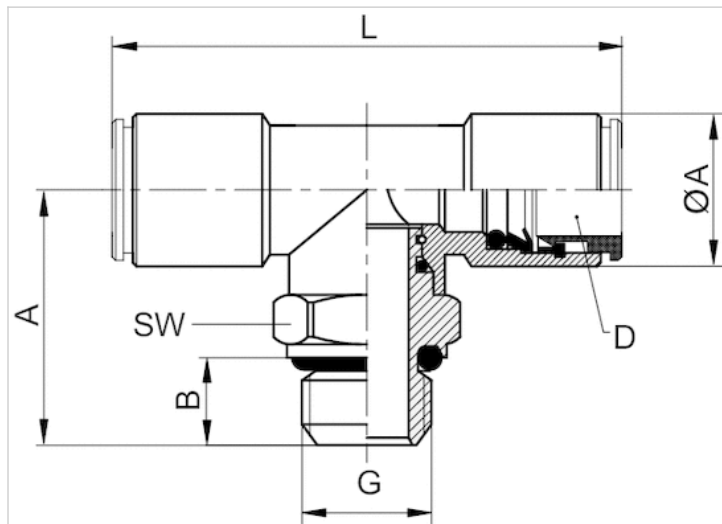

Dimensions

Part No.	Port D	Port G	A	Ø A	B	C	E	SW
R412004889	Ø 4	M5	18	9	4	15	34	9
R412004904	Ø 4	G 1/8	20	9	5	15	34	13
R412004905	Ø 6	G 1/8	22.5	12	5	16	42	13
R412004906	Ø 8	G 1/8	22.5	14	5	18	43	13
R412004907	Ø 6	G 1/4	24.5	12	6.5	16	42	16
R412004908	Ø 8	G 1/4	24.5	14	6.5	18	43	16