

# Series QR2-F Heat-resistant

- T-plug connector
- push-in fitting
- Ø 4 Ø 6 Ø 8 Ø 10 Ø 12
- push-in fitting
- Ø 4 Ø 6 Ø 8 Ø 10 Ø 12
- QR2-F-RTK



Working pressure min./max.

-0,95 ... 16 bar

Ambient temperature min./max.

-20 ... 150 °C

Weight

See table below

## Technical data

Part No.	Port G	Port D	Delivery unit	Weight
1823381050	Ø 4	Ø 4	10 piece	0,013 kg
1823381051	Ø 6	Ø 6	10 piece	0,015 kg
1823381052	Ø 8	Ø 8	10 piece	0,023 kg
1823381053	Ø 10	Ø 10	10 piece	0,048 kg
R412007732	Ø 12	Ø 12	10 piece	0,051 kg

Weight per piece

## Technical information

The series QR1 (plastic) and QR2 (metal) can not be combined

For further information about assembling and tolerances of adaptable tubing can be found in the "Technical information" document (available in the MediaCentre).

## Technical information

Material	
Housing	Brass, nickel-plated
Seal	Fluorocaoutchouc
Tooth lock washer	Stainless steel
Release ring	Brass, nickel-plated

## Dimensions

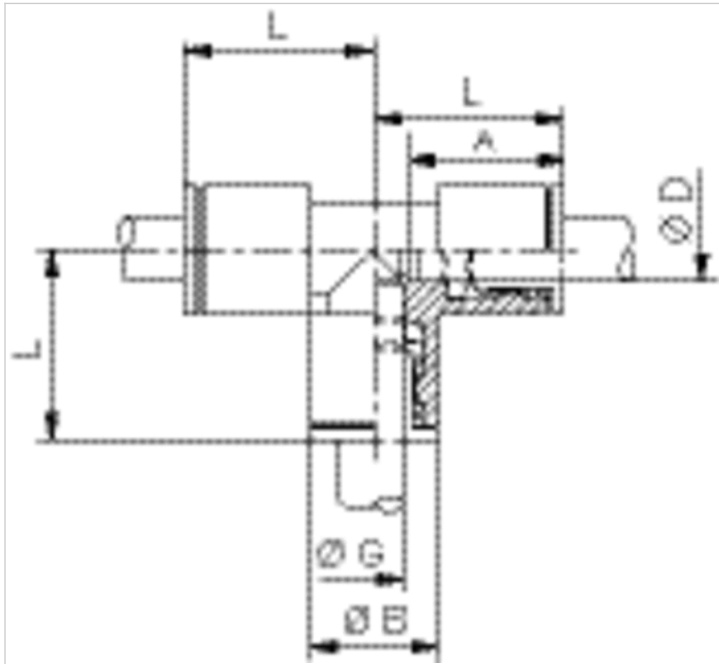

## Dimensions

Part No.	Port D	Port G	Ø B	L	A*
1823381050	Ø 4	Ø 4	9	17.5	15
1823381051	Ø 6	Ø 6	11	19.5	16
1823381052	Ø 8	Ø 8	13	23	18
1823381053	Ø 10	Ø 10	15	25	19
R412007732	Ø 12	Ø 12	17	27	20

\*