

Series QR2-C, stainless steel

- Elbow fitting
- External thread
- G 1/4
- push-in fitting
- Ø 6
- QR2-C-RVT
- suitable for use in food processing



Working pressure min./max.	-0,95 ... 16 bar
Ambient temperature min./max.	-20 ... 150 °C
Weight	See table

Technical data

Part No.	Port G	Port D	Delivery unit	Weight
R412005617	M5	Ø 4	2 piece	0,008 kg
R412026810	M5	Ø 6	2 piece	0,009 kg
R412004898	G 1/8	Ø 4	2 piece	0,012 kg
R412004899	G 1/8	Ø 6	2 piece	0,02 kg
R412004900	G 1/8	Ø 8	2 piece	0,022 kg
R412004901	G 1/4	Ø 6	2 piece	0,024 kg
R412005616	G 1/4	Ø 8	2 piece	0,025 kg
R412004902	G 3/8	Ø 10	1 piece	0,043 kg
R412004903	G 3/8	Ø 12	1 piece	0,06 kg
R412026809	G 1/2	Ø 12	1 piece	0,06 kg

Technical information

The series QR1 (plastic) and QR2 (metal) can not be combined
Thread seal with captive O-ring

For further information about assembling and tolerances of adaptable tubing can be found in the "Technical information" document (available in the MediaCentre).

Technical information

Material

Housing	Stainless steel
Seal	Fluorocautchouc
Tooth lock washer	Stainless steel
Release ring	Stainless steel
Thread	Stainless steel

Dimensions

Dimensions

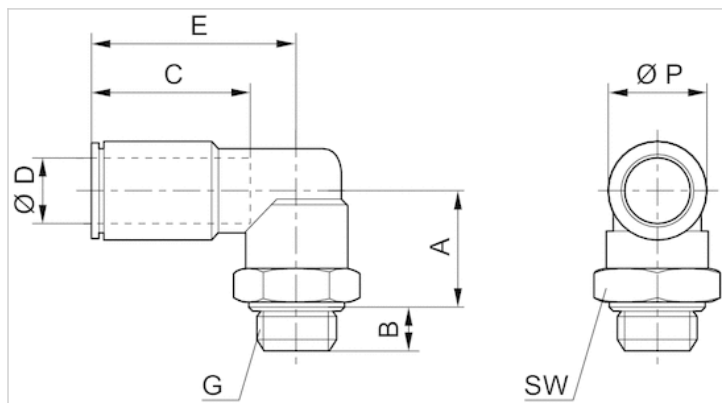

Dimensions

Part No.	Port D	Port G	A	B	C	E	SW	Ø P
R412005617	Ø 4	M5	15	4	15	14.5	9	9
R412026810	Ø 6	M5	16	4	15	14.5	9	9
R412004898	Ø 4	G 1/8	14.5	5.5	15	19.5	13	9
R412004899	Ø 6	G 1/8	16.5	5.5	16	19.5	13	11
R412004900	Ø 8	G 1/8	18.5	5.5	18	19.5	13	13
R412004901	Ø 6	G 1/4	15.5	6.5	16	20.5	16	11
R412005616	Ø 8	G 1/4	17.5	6.5	18	20.5	16	13
R412004902	Ø 10	G 3/8	18.5	7	19	24	21	16
R412004903	Ø 12	G 3/8	21	7	19	26.5	21	19
R412026809	Ø 12	G 1/2	33,5	11	19	28.5	20	19